

**NOTICE!!**

**These documents have been scanned!**

**Do not place un-scanned documents beneath this notice!**

**Do not remove this notice from this file!**

GPO Jacket No. 560-102  
Print Order 61540  
Rise Business Services, LLC  
Job=AZ15 5/16/2019



Box Number= AZ15056



Claim Begin-End: AMC410427-AMC410448

1 Initial Receipt



AZ15056-17

AMC409378-AMC410492

**United States Department of the Interior**  
**Bureau of Land Management**  
 LANDS/RECREATION & PLANNING  
 ONE N CENTRAL AVE  
 PHOENIX, AZ 85004 -2203  
 Phone: 602-417-9200

Receipt

No: 2425545

<b>Transaction #:</b> 2501024		<b>ENTERED INTO COMPUTER</b>
<b>Date of Transaction:</b> 09/06/2011		
<b>CUSTOMER:</b>		
BLUEFIRE GEM CO LLC PO BOX 1916 TUBAC, AZ 85646-1916 US	<i>M</i> <b>SEP 17 2011</b>	

LINE #	QTY	DESCRIPTION	REMARKS	UNIT PRICE	TOTAL
1	22.00	LOCATABLE MINERALS / MINING CLAIMS-NEW, UNADJUD, ONE OR MORE AUTH NOS / NEW MINING CLAIM LOCATION FEE \$34 <b>CASES:</b> AMC410427/\$34.00, AMC410428/\$34.00, AMC410429/ \$34.00, AMC410430/\$34.00, AMC410431/\$34.00, AMC410432/ \$34.00, AMC410433/\$34.00, AMC410434/\$34.00, AMC410435/ \$34.00, AMC410436/\$34.00, AMC410437/\$34.00, AMC410438/ \$34.00, AMC410439/\$34.00, AMC410440/\$34.00, AMC410441/ \$34.00, AMC410442/\$34.00, AMC410443/\$34.00, AMC410444/ \$34.00, AMC410445/\$34.00, AMC410446/\$34.00, AMC410447/ \$34.00, AMC410448/\$34.00		- n/a -	748.00
2	22.00	LOCATABLE MINERALS / MINING CLAIMS-NEW, UNADJUD, ONE OR MORE AUTH NOS / NEW MINING CLAIM MAINT FEE \$140 <b>CASES:</b> AMC410427/\$140.00, AMC410428/\$140.00, AMC410429/ \$140.00, AMC410430/\$140.00, AMC410431/\$140.00, AMC410432/ \$140.00, AMC410433/\$140.00, AMC410434/\$140.00, AMC410435/ \$140.00, AMC410436/\$140.00, AMC410437/\$140.00, AMC410438/ \$140.00, AMC410439/\$140.00, AMC410440/\$140.00, AMC410441/ \$140.00, AMC410442/\$140.00, AMC410443/\$140.00, AMC410444/ \$140.00, AMC410445/\$140.00, AMC410446/\$140.00, AMC410447/ \$140.00, AMC410448/\$140.00		- n/a -	3080.00
3	22.00	LOCATABLE MINERALS / MINING CLAIMS-NEW, UNADJUD, ONE OR MORE AUTH NOS / NEW MINING CLAIM PROCESSING FEE \$15 <b>CASES:</b> AMC410427/\$15.00, AMC410428/\$15.00, AMC410429/ \$15.00, AMC410430/\$15.00, AMC410431/\$15.00, AMC410432/ \$15.00, AMC410433/\$15.00, AMC410434/\$15.00, AMC410435/ \$15.00, AMC410436/\$15.00, AMC410437/\$15.00, AMC410438/ \$15.00, AMC410439/\$15.00, AMC410440/\$15.00, AMC410441/ \$15.00, AMC410442/\$15.00, AMC410443/\$15.00, AMC410444/ \$15.00, AMC410445/\$15.00, AMC410446/\$15.00, AMC410447/ \$15.00, AMC410448/\$15.00		- n/a -	330.00
<b>TOTAL:</b>					<b>\$4,158.00</b>

**PAYMENT INFORMATION**

NOTE: Items will appear on credit card statement as "Bureau of Land Mgmt CO".

1	AMOUNT:	4158.00	POSTMARKED:	N/A
	TYPE:	CREDIT CARD	RECEIVED:	09/06/2011
	NAME:	BLUEFIRE GEM CO LLC PO BOX 1916 TUBAC AZ 85646-1916 US		
	CARD NO:	XXXXXXXXXXXX4105	AUTH CODE:	64628P
	NAME ON CARD:	VINCENT M GULINO		
	EXPIRES:	10/2013		
	SIGNATURE:			

**REMARKS**

This receipt was generated by the automated BLM Collections and Billing System and is a paper representation of a portion of the official electronic record contained therein.

**NOTICE!!**

**These documents have been scanned!**

**Do not place un-scanned documents beneath this notice!**

**Do not remove this notice from this file!**

GPO Jacket No. 560-102  
Print Order 61540  
Rise Business Services, LLC  
Job=AZ15 5/16/2019



Box Number= AZ15056



Claim Begin-End: AMC410427-AMC410448

2 Correspondence



AZ15056-17

AMC409378-AMC410492



# United States Department of the Interior



BUREAU OF LAND MANAGEMENT  
Arizona State Office  
One North Central Avenue, Suite 800  
Phoenix, Arizona 85004-4427  
www.blm.gov/az/

DEC 20 2017

In Reply Refer To:  
3830 (9200) PB  
AMC410427

CERTIFIED MAIL - RETURN RECEIPT REQUESTED No. 7017 0190 0000 4056 5966

## DECISION

BLUE FIRE GEM CO LLC : This decision affects those claims shown  
PO BOX 4688 : in the block below.  
TUBAC, AZ 85646-4688 :

---

AMC410427 – AMC410430  
CLOSED TO ENTRY #4 – CLOSED TO ENTRY #7

---

### MINING CLAIMS DECLARED FORFEITED

The mining claims listed above have been declared forfeited as of September 1, 2017, for failure to timely file the required maintenance fee payment or small miner’s maintenance fee waiver (waiver).

Claimants are required to pay an annual non-refundable maintenance fee of \$155 per 20 acres or portion thereof, or submit a waiver, on or before September 1 of each year. These requirements were established by 30 U.S.C. 28f-l, as amended, and 43 CFR 3834 and 3835.

Our records do not show receipt of a maintenance fee payment or small miner waiver filed on or before the due date. Therefore, the claims listed above are forfeited.

### Reclamation Requirements

This decision does not relieve you of the liability for reclamation of all areas disturbed by your activities on lands covered by the subject mining claim(s) and/or site(s). After you complete the reclamation, you must notify the authorized officer of the appropriate surface managing agency so that the authorized officer may conduct a final site inspection and determine whether you may be released from liability. If you fail to reclaim the land to the satisfaction of the authorized officer,

the surface management agency may cite you for noncompliance under its surface management regulations. For land administered by the Bureau of Land Management (BLM), if you fail to reclaim the land to the satisfaction of the authorized officer as required in 43 CFR Subpart 3809, BLM will issue an order of noncompliance under 43 CFR 3809.601(a). If you fail to comply with the non-compliance order, BLM may take further action under 43 CFR 3809.604. Failure to conduct reclamation is a prohibited act that may subject you to criminal penalties. See 43 CFR 3809.605(h) and 43 CFR 3809.700.

### Appeal Procedures

This decision may be appealed to the Interior Board of Land Appeals, Office of the Secretary, in accordance with the regulations contained in 43 CFR, Part 4, and the enclosed Form 1842-1. If an appeal is taken, your notice of appeal must be filed in this office (at the above address) within 30 days from receipt of this decision. The appellant has the burden of showing that the decision appealed from is in error.

If you wish to file a petition pursuant to regulation 43 CFR 4.21 (58 FR 4939, January 19, 1993) for a stay of the effectiveness of this decision during the time that your appeal is being reviewed by the Board, the petition for a stay must accompany your notice of appeal. A petition for a stay is required to show sufficient justification based on the standards listed below. Copies of the notice of appeal and petition for a stay **must** also be submitted to each party named in this decision and to the Interior Board of Land Appeals and to the appropriate Office of the Solicitor (see 43 CFR 4.413) at the same time the original documents are filed with this office. If you request a stay, you have the burden of proof to demonstrate that a stay should be granted.

### Standards for Obtaining a Stay

Except as otherwise provided by law or other pertinent regulation, a petition for a stay of a decision pending appeal shall show sufficient justification based on the following standards:

- (1) The relative harm to the parties if the stay is granted or denied,
- (2) The likelihood of the appellant's success on the merits,
- (3) The likelihood of immediate and irreparable harm if the stay is not granted, and
- (4) Whether the public interest favors granting the stay.

Please include your AMC serial number(s) on all correspondence. If additional information is required, please call Pauline Brown at 602-417-9360.

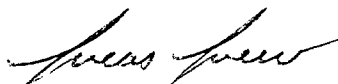

Lucas Lucero  
Deputy State Director  
Lands, Minerals, and Energy Division

Enclosure

**SENDER: COMPLETE THIS SECTION**

- Complete items 1, 2, and 3.
- Print your name and address on the reverse so that we can return the card to you.
- Attach this card to the back of the mailpiece, or on the front if space permits.

1. Addressee to:

BLUE FIRE GEM CO LLC  
 PO BOX 4688  
 TUBAC AZ 85646-4688  
 9200/PB/AMC410427



9590 9402 2630 6336 1239 84

2. Article Number (Transfer from service label)

7017 0190 0000 4056 5966

PS Form 3811, July 2015 PSN 7530-02-000-9053

**COMPLETE THIS SECTION ON DELIVERY**

A. Signature

X

 Agent Addressee

B. Received by (Printed Name)

C. Date of Delivery

 D. Is delivery address different from item 1?  Yes  
 If YES, enter delivery address below:  No

3. Service Type

- Adult Signature
- Adult Signature Restricted Delivery
- Certified Mail®
- Certified Mail Restricted Delivery
- Collect on Delivery
- Collect on Delivery Restricted Delivery
- Insured Mail
- Insured Mail Restricted Delivery (over \$500)
- Priority Mail Express®
- Registered Mail™
- Registered Mail Restricted Delivery
- Return Receipt for Merchandise
- Signature Confirmation™
- Signature Confirmation Restricted Delivery

Domestic Return Receipt

USPS TRACKING #



9590 9402 2630 6336 1239 84



First-Class Mail  
Postage & Fees Paid  
USPS  
Permit No. G-10

**United States  
Postal Service**

• Sender: Please print your name, address, and ZIP+4® in this box •

U.S. DEPARTMENT OF THE INTERIOR  
BUREAU OF LAND MANAGEMENT  
ARIZONA STATE OFFICE  
ONE NORTH CENTRAL AVENUE, SUITE 800  
PHOENIX, AZ 85004-4427

4-442700

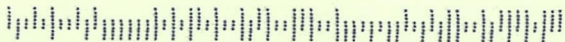





# United States Department of the Interior



BUREAU OF LAND MANAGEMENT

Arizona State Office

One North Central Avenue, Suite 800

Phoenix, Arizona 85004-4427

[www.blm.gov/az/](http://www.blm.gov/az/)

January 17, 2013

In Reply Refer To:  
3800 (9310) RE  
AMC410427

CERTIFIED MAIL - RETURN RECEIPT REQUESTED No. 7012 2210 0000 8740 5685

## DECISION

GULINO VINCENT : This decision affects those claims shown  
PO BOX 2721 : in the block below:  
TUBAC, AZ 85646-2721 :

---

AMC410439 - 410443  
RESTRICTED AREA #1 - #5

---

## MINING CLAIMS DECLARED FORFEITED

The mining claims listed above have been declared forfeited for failure to file the required maintenance fee payment or small miner's maintenance fee waiver (waiver).

Claimants are required to pay an annual non-refundable maintenance fee of \$140, or submit a waiver, on or before September 1 of each year. These requirements were established by 30 (United States Code) 28-f-k, as amended, and 43 Code of Federal Regulations (CFR) 3834 and 3835.

Our records do not show receipt of a maintenance fee payment, or waiver received on or before September 1, 2012, for the 2013 assessment year, for the claims listed above. Therefore, the claims are forfeited.

This decision does not relieve you of the liability for reclamation of all areas disturbed by your activities on lands covered by the subject mining claim(s) and/or site(s). After you complete the reclamation, you must notify the authorized officer of the appropriate surface managing agency so that the authorized officer may conduct a final site inspection and determine whether you may be released from liability.

**SENDER: COMPLETE THIS SECTION**

- Complete items 1, 2, and 3. Also complete item 4 if Restricted Delivery is desired.
- Print your name and address on the reverse so that we can return the card to you.
- Attach this card to the back of the mailpiece, or on the front if space permits.

1. Article Addressed to:

GULINO VINCENT  
 PO BOX 2721  
 TUBAC, AZ 85646-2721  
 AMC410427 (AZ931-RE)

2. Article Number  
 (Transfer from service label)

7012 2210 0000 8740 5685

**COMPLETE THIS SECTION ON DELIVERY**

A. Signature

*[Handwritten Signature]*  Agent  
 Addressee

B. Received by (Printed Name)

C. Date of Delivery

D. Is delivery address different from item 1?  Yes  
 If YES, enter delivery address below:  No



3. Service Type

- Certified Mail     Express Mail  
 Registered     Return Receipt for Merchandise  
 Insured Mail     C.O.D.

4. Restricted Delivery? (Extra Fee)  Yes

UNITED STATES POSTAL SERVICE

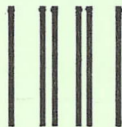

First-Class Mail  
Postage & Fees Paid  
USPS  
Permit No. G-10

- Sender: Please print your name, address, and ZIP+4 in this box •

**Bureau of Land Management  
Arizona State Office (AZ931-RE)  
One North Central Avenue, Ste 800  
Phoenix, AZ 85004-4427**

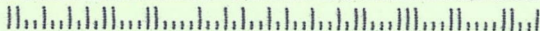

If you fail to reclaim the land to the satisfaction of the authorized officer, the surface management agency may cite you for noncompliance under its surface management regulations.

For land administered by the Bureau of Land Management (BLM), if you fail to reclaim the land to the satisfaction of the authorized officer as required in 43 CFR Subpart 3809, BLM will issue an order of noncompliance under 43 CFR 3809.601(a). If you fail to comply with the noncompliance order, BLM may take further action under 43 CFR 3809.604. Failure to conduct reclamation is a prohibited act that may subject you to criminal penalties. See 43 CFR 3809.605(h) and 43 CFR 3809.700.

### Appeal Procedures

This decision may be appealed to the Interior Board of Land Appeals, Office of the Secretary, in accordance with the regulations contained in 43 CFR, Part 4, and the enclosed Form 1842-1. If an appeal is taken, your notice of appeal must be filed in this office (at the above address) within 30 days from receipt of this decision. The appellant has the burden of showing that the decision appealed from is in error.

If you wish to file a petition pursuant to regulation 43 CFR 4.21 (58 FR 4939, January 19, 1993) for a stay of the effectiveness of this decision during the time that your appeal is being reviewed by the Board, the petition for a stay must accompany your notice of appeal. A petition for a stay is required to show sufficient justification based on the standards listed below. Copies of the notice of appeal and petition for a stay **must** also be submitted to each party named in this decision and to the Interior Board of Land Appeals and to the appropriate Office of the Solicitor (see 43 CFR 4.413) at the same time the original documents are filed with this office. If you request a stay, you have the burden of proof to demonstrate that a stay should be granted.

### Standards for Obtaining a Stay

Except as otherwise provided by law or other pertinent regulation, a petition for a stay of a decision pending appeal shall show sufficient justification based on the following standards:

- (1) The relative harm to the parties if the stay is granted or denied,
- (2) The likelihood of the appellant's success on the merits,
- (3) The likelihood of immediate and irreparable harm if the stay is not granted, and
- (4) Whether the public interest favors granting the stay.

Please include your AMC serial number(s) on all correspondence. If additional information is required, please call Rod Ebert at 602-417-9397.

*Rebecca Heick*

Rebecca Heick  
Group Administrator  
Lands and Minerals

Enclosure

Appeal Form 1842-1

**NOTICE!!**

**These documents have been scanned!**

**Do not place un-scanned documents beneath this notice!**

**Do not remove this notice from this file!**

GPO Jacket No. 560-102  
Print Order 61540  
Rise Business Services, LLC  
Job=AZ15 5/16/2019



Box Number= AZ15056



Claim Begin-End: AMC410427-AMC410448

3 Transfers



AZ15056-17

AMC409378-AMC410492

**NO  
DOCUMENTS  
FOUND**

NO DOCUMENTS FOUND  
NO DOCUMENTS FOUND

**NOTICE!!**

**These documents have been scanned!**

**Do not place un-scanned documents beneath this notice!**

**Do not remove this notice from this file!**

GPO Jacket No. 560-102  
Print Order 61540  
Rise Business Services, LLC  
Job=AZ15 5/16/2019



Box Number= AZ15056



Claim Begin-End: AMC410427-AMC410448

4 Miscellaneous



AZ15056-17

AMC409378-AMC410492

410427

413977

**Authorized Date** 10/16/2012

**Instructions to Accounts** AZ BLM REFUND \$10 TO DWIGHT WILLIAMS FOR  
OVERPAYMENT OF MAINTENANCE FEES FOR AMC417345.  
RECEIPT# 2647440. RE.

**Login ID** 4105

**Entry Date** 10/16/2012

**Total Amount** \$140.00



Amc 410 427  
Amc 413977

**MAINTENANCE FEE PAYMENT** Bluefire Gold Co. LLC ✓

Claimant Name: Bluefire Gem Co. LLC.

Address: P.O. Box 1916

City: Tubac State: AZ Zip: 85646

Telephone: 732-233-6366

E-mail address: Southern Skies Opal@questoffice.net

Signature: [Signature]

Check here if this is a change of address.

RECEIVED  
BLM AZ STATE OFFICE  
2012 AUG 27 P 4:19  
PHOENIX, ARIZONA  
BLM  
Date  
Stamp

LINE NO.	AMC NUMBER	CLAIM/SITE NAME	COUNTY RECORDER DATA (If available)	TWP	RNG	SEC
1	410427	Closed to Entry #4	2011 - 06853	22S	11E	20
2	410428	Closed to Entry #5	2011 - 06854	22S	11E	20
3	410429	Closed to Entry #6	2011 - 06855	22S	11E	20
4	410430	closed to Entry #7	2011 - 06856	22S	11E	20
5	410431	Closed to Entry #8	" - 06857	22S	11E	25
6	410432	closed to Entry #9	" - 06858	22S	11E	25
7	410433	closed to Entry #10	" 06859	22S	11E	25
8	410434	closed to Entry #11	" - 06860	22S	11E	25
9	410435	closed to Entry #12	" - 06861	22S	11E	25
10	410436	closed to Entry #13	" 06862	22S	11E	25

*duplicate*

List additional claims on Form MCF114.

**Bureau of Land Management**  
**Arizona State Office**  
www.blm.gov/az/

No. of Claims: 20 x \$140 = \$140.00  
 Check No: 2615 Init. AA  
 Receipt No.: 2442091  
 For BLM Use Only

Form: MCF112  
Revised July 2009

This form is available from the Arizona Department of Mines and Mineral Resources and may be reproduced.

Amc 410 436 listed twice. Refund \$140

*\$140 refunded authorized for duplicate maintenance fee paid on Amc 410436.*

ENTERED INTO COMPUTER RE 10-26-12

9/9/12 AT

**SUPPLEMENTAL ATTACHMENT**

May be used with the following forms for listing additional mining claims:

Check One.

- Affidavit of Performance of Annual Work
- Maintenance Fee Payment
- Notice of Intent to Hold Mining Claims
- Notice of Non-Liability for Labor and Materials Furnished

BLM  
Date  
Stamp

RECEIVED  
BLM AZ STATE OFFICE  
PHOENIX, ARIZONA  
2012 AUG 27 P 4:59

LINE NO.	AMC NUMBER	CLAIM/SITE NAME	COUNTY RECORDER DATA (If available)	TWP	RNG	SEC
11	410436	closed to Entry #13	2011-06862	22S	11E	25
12	410437	closed to Entry #14	" - 06863	22S	11E	25
13	410438	closed to Entry #15	" - 06864	22S	11E	25
14	413978	Closed to Entry #16	2012-00589	22S	11E	25
15	413977	Closed to Entry #17	2012-00590	22S	11E	25
16	410444	VAN Nostrand-McCafferty Mine #1	20112640214	21S	10E	18
17	410445	VAN Nostrand-McCafferty Mine #2	20112640215	21S	10E	18
18	410446	VAN Nostrand-McCafferty Mine #3	20112640216	21S	10E	18
19	410447	VAN Nostrand-McCafferty Mine #4	20112640217	21S	10E	18
20	410448	VAN Nostrand-McCafferty Mine #5	20112640218	21S	10E	7

Form MCF114  
Revised June 2005

This form is available from the Arizona Department of Mines & Mineral Resources and may be reproduced.

Bluefore Gem  
P.O. Box 1916  
Tubac, Az.  
85646.

B.L.M.  
AZ. State Office  
1 North Central Avenue, Suite 800  
Phoenix, Az.  
85004



UNITED STATES POSTAL SERVICE

Flat Rate Mailing Envelope

Visit us at [usps.com](http://usps.com)

Bluefore Gem  
P.O. Box 1916  
Tubac, Az.  
85646.

B.L.M.  
AZ. State Office  
1 North Central Avenue, Suite 800  
Phoenix, Az.  
85004



PS00001000014

EP14F  
OD: 12.5 x 9.5

PLEASE PRESS FIRMLY



UNITED STATES POSTAL SERVICE  
PITNEY BOWES  
02 1P \$ 005.90<sup>00</sup>  
0001678955 AUG 24 2012  
MAILED FROM ZIP CODE 85646



Flat Rate Mailing Envelope

Visit us at [usps.com](http://usps.com)

Schedule package pickup right from your home or office at [usps.com/pickup](http://usps.com/pickup)  
Print postage online

United States Postal Service<sup>®</sup>  
**DELIVERY CONFIRMATION™**



APPLY:  
at the  
[usps.gov](http://usps.gov)

**PRIORITY MAIL**  
UNITED STATES POSTAL SERVICE

For Domestic and International Use

From Bluefire Gem  
P.O. Box 1916  
Tubac, AZ 85646

TO BLM,  
AZ State Office #  
1 North Central Ave. 800  
Phoenix, Az. 85004

Label 226, January 2008



PS00001000014



EPI4F November 2011 © U.S. Postal Service  
This packaging is the property of the U.S. Postal Service<sup>®</sup> and is provided solely for use in sending Priority Mail<sup>®</sup> shipments.  
Misuse may be a violation of federal law. This packaging is not for resale. EPI4F © U.S. Postal Service, November 2011. All rights reserved.

**United States Department of the Interior**  
**Bureau of Land Management**  
 LANDS/RECREATION & PLANNING  
 ONE N CENTRAL AVE  
 PHOENIX, AZ 85004 -2203  
 Phone: 602-417-9200

Receipt

No: 2642091

<b>Transaction #:</b> 2722781	
<b>Date of Transaction:</b> 08/28/2012	
CUSTOMER:	
BLUE FIRE GEM COMPANY LLC PO BOX 1916 TUBAC, AZ 85646-1916 US	

LINE #	QTY	DESCRIPTION	REMARKS	UNIT PRICE	TOTAL
1	1.00	LOCATABLE MINERALS / MINING CLAIMS-NOT NEW-UNADJUD, ONE AUTH NO. ONLY / MINING CLAIM MONEY RECEIVED <b>CASES: AMC410427/\$2800.00</b>	MAINT FEE PYMNT (20) 2013	- n/a -	2800.00
<b>TOTAL:</b>					<b>\$2,800.00</b>

PAYMENT INFORMATION			
1	AMOUNT:	2800.00	POSTMARKED: N/A
	TYPE:	CHECK	RECEIVED: 08/27/2012
	CHECK NO:	2615	
	NAME:	OLLENDICK, ROBERT W PO BOX 1916 TUBAC AZ 85646-1916 US	

REMARKS

This receipt was generated by the automated BLM Collections and Billing System and is a paper representation of a portion of the official electronic record contained therein.

*\$140 refund authorized for duplicate maint fee paid on AMC ~~410427~~ 410436  
 RE 10/16/12*

**NOTICE!!**

**These documents have been scanned!**

**Do not place un-scanned documents beneath this notice!**

**Do not remove this notice from this file!**

GPO Jacket No. 560-102  
Print Order 61540  
Rise Business Services, LLC  
Job=AZ15 5/16/2019



Box Number= AZ15056



Claim Begin-End: AMC410427-AMC410448

5 Annual Filings



AZ15056-17

AMC409378-AMC410492

UNITED STATES  
DEPARTMENT OF THE INTERIOR  
BUREAU OF LAND MANAGEMENT  
**MAINTENANCE FEE PAYMENT FORM FOR  
LODE CLAIMS, MILL SITES, AND TUNNEL SITES**

AMC 410427  
413977

Remitter Name: Bluefire Gem Co, LLC,  
Mailing Address: P.O. Box 4688  
City, State, Zip: Tubac, Az. 85646

Check here if this is a change of address.

**FOR COUNTY RECORDER'S USE**

No. of claims/sites 15  
x \$155 per claim/site  
Total due BLM \$ 2325<sup>00</sup>

- The maintenance fee may be paid by cash, check, money order, Bureau of Land Management (BLM) Declining Deposit Account, or credit card (VISA, American Express, Discover, or MasterCard). Payments must be remitted to the BLM State Office where your claim or site is recorded and received on or before September 1. If the payment is mailed, the envelope must be postmarked by a bona fide delivery service on or before September 1 and received at the proper BLM State Office within 15 calendar days after the due date. Payments may also be made by telephone using a credit card. A complete listing of BLM State Offices with their addresses and phone numbers can be found at <http://www.blm.gov>.
- The maintenance fee for the following claim(s)/site(s) applies to the assessment year 2019

CLAIM/SITE NAME	BLM SERIAL NO.
Closed To Entry #8	410 - 431
Closed To Entry #9	410 - 432
Closed To Entry #10	410 - 433
Closed To Entry #11	410 - 434
Closed To Entry #12	416 - 435
Closed To Entry #13	410 - 436
Closed To Entry #14	410 - 437
Closed To Entry #15	410 - 438
Closed To Entry #16	413 - 978
Closed To Entry #17	413 - 977

Use a separate sheet for additional claim/site names, serial numbers, and claimant names and addresses.

(Continued on page 2)

**ENTERED**  
AUG 24 2018  
BY: [Signature]

#4237014

RECEIVED  
STATE OFFICE  
5 02:35  
TUBAC, ARIZONA



UNITED STATES  
DEPARTMENT OF THE INTERIOR  
BUREAU OF LAND MANAGEMENT  
**MAINTENANCE FEE PAYMENT FORM FOR  
LODE CLAIMS, MILL SITES, AND TUNNEL SITES**

Remitter Name: Bluefire Gem Co. LLC,  
Mailing Address: P.O. Box 4688  
City, State, Zip: Tubac, Az, 85646

Check here if this is a change of address.

**FOR COUNTY RECORDER'S USE**

No. of claims/sites 15  
x \$155 per claim/site  
Total due BLM \$ 2325<sup>00</sup>

- The maintenance fee may be paid by cash, check, money order, Bureau of Land Management (BLM) Declining Deposit Account, or credit card (VISA, American Express, Discover, or MasterCard). Payments must be remitted to the BLM State Office where your claim or site is recorded and received on or before September 1. If the payment is mailed, the envelope must be postmarked by a bona fide delivery service on or before September 1 and received at the proper BLM State Office within 15 calendar days after the due date. Payments may also be made by telephone using a credit card. A complete listing of BLM State Offices with their addresses and phone numbers can be found at <http://www.blm.gov>.
- The maintenance fee for the following claim(s)/site(s) applies to the assessment year 2019

CLAIM/SITE NAME	BLM SERIAL NO.
<u>Van Nostrand-McCafferty Mine #1</u>	<u>410-444</u>
<u>Van Nostrand-McCafferty Mine #2</u>	<u>410-445</u>
<u>Van Nostrand-McCafferty Mine #3</u>	<u>410-446</u>
<u>Van Nostrand-McCafferty Mine #4</u>	<u>410-447</u>
<u>VAN Nostrand-McCafferty Mine #5</u>	<u>410 448</u>

RECEIVED  
BLM AZ STATE OFFICE  
2018 AUG 15 P 2:30  
PHOENIX, ARIZONA

Use a separate sheet for additional claim/site names, serial numbers, and claimant names and addresses.

**United States Department of the Interior**  
**Bureau of Land Management**  
 DIV OF LANDS, MINRLS & ENERGY  
 ONE N CENTRAL AVE  
 PHOENIX, AZ 85004 -4427  
 Phone: 602-417-9200

Receipt

No: 4237014

<b>Transaction #:</b> 4352395	
<b>Date of Transaction:</b> 08/16/2018	
CUSTOMER:	
BLUE FIRE GEM COMPANY LLC PO BOX 4688 TUBAC, AZ 85646-4688 US	

LINE #	QTY	DESCRIPTION	REMARKS	UNIT PRICE	TOTAL
1	1.00	LOCATABLE MINERALS / MINING CLAIMS- NOT NEW-UNADJUD, ONE AUTH NO. ONLY / MINING CLAIM MONEY RECEIVED <b>CASES:</b> AMC410431/\$2325.00	MAINT 2019/15	- n/a -	2325.00
<b>TOTAL:</b>					<b>\$2,325.00</b>

PAYMENT INFORMATION			
1	AMOUNT:	2325.00	POSTMARKED: N/A
	TYPE:	CHECK	RECEIVED: 08/15/2018
	CHECK NO:	1211	
	NAME:	BLUE FIRE GEM COMPANY LLC PO BOX 4688 TUBAC AZ 85646-4688 US	

REMARKS

This receipt was generated by the automated BLM Collections and Billing System and is a paper representation of a portion of the official electronic record contained therein.

Southern Skies Opal, LLC  
P.O. Box ~~4688~~ 4688  
Tubac, AZ 85646-~~4688~~  
732-233-6366

RECEIVED  
STATE OFFICE  
2018 AUG 15 P 2:36  
PHOENIX, ARIZONA

CERTIFIED MAIL<sup>®</sup> PHOENIX



1012  
13 AUG '18  
PM 11

7015 0640 0007 5501 4287

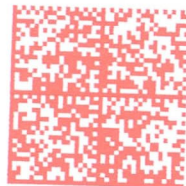

U.S. OFFICIAL MAIL **US POSTAGE**  
PENALTY FOR PRIVATE USE **\$06.67<sup>0</sup>**  
\$300 **First-Class**  
Mailed From 85646  
08/13/2018  
032A 0061856771

Bureau of Land Management  
One North Central Ave.  
Suite 800 (8th Floor)  
Phoenix, Az.



85004-4427

85004-4427 CO41

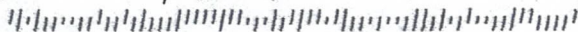

UNITED STATES  
DEPARTMENT OF THE INTERIOR  
BUREAU OF LAND MANAGEMENT  
**MAINTENANCE FEE PAYMENT FORM FOR  
LODE CLAIMS, MILL SITES, AND TUNNEL SITES**

410427  
413977

Remitter Name: Bluefire Gem Co, LLC.  
Mailing Address: P.O. Box 4600  
City, State, Zip: Tubac, Az. 85646

Check here if this is a change of address.

**FOR COUNTY RECORDER'S USE**

No. of claims/sites 15  
x \$155 per claim/site  
Total due BLM \$ 2325<sup>00</sup>

- The maintenance fee may be paid by cash, check, money order, Bureau of Land Management (BLM) Declining Deposit Account, or credit card (VISA, American Express, Discover, or MasterCard). Payments must be remitted to the BLM State Office where your claim or site is recorded and received on or before September 1. If the payment is mailed, the envelope must be postmarked by a bona fide delivery service on or before September 1 and received at the proper BLM State Office within 15 calendar days after the due date. Payments may also be made by telephone using a credit card. A complete listing of BLM State Offices with their addresses and phone numbers can be found at <http://www.blm.gov>.
- The maintenance fee for the following claim(s)/site(s) applies to the assessment year 2016

CLAIM/SITE NAME	BLM SERIAL NO.
Closed To Entry # 8	410-4317
Closed To Entry # 9	410-432
Closed To Entry # 10	410-433
Closed To Entry # 11	410-434
Closed To Entry # 12	410-435
Closed To Entry # 13	410-436
Closed To Entry # 14	410-437
Closed To Entry # 15	410-438
Closed To Entry # 16	413-9787
Closed To Entry # 17	413-977

Use a separate sheet for additional claim/site names, serial numbers, and claimant names and addresses.

# 3937392

(Continued on page 2)

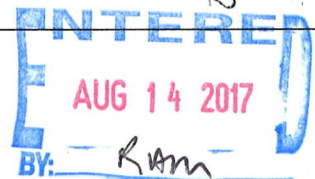

UNITED STATES  
DEPARTMENT OF THE INTERIOR  
BUREAU OF LAND MANAGEMENT  
**MAINTENANCE FEE PAYMENT FORM FOR  
LODE CLAIMS, MILL SITES, AND TUNNEL SITES**

Remitter Name: Blue Fire Gem Co. LLC.

Mailing Address: P.O. Box 4688

City, State, Zip: Tubac, Az, 85646

Check here if this is a change of address.

**FOR COUNTY RECORDER'S USE**

No. of claims/sites 15  
x \$155 per claim/site  
Total due BLM \$ 2325<sup>00</sup>

- The maintenance fee may be paid by cash, check, money order, Bureau of Land Management (BLM) Declining Deposit Account, or credit card (VISA, American Express, Discover, or MasterCard). Payments must be remitted to the BLM State Office where your claim or site is recorded and received on or before September 1. If the payment is mailed, the envelope must be postmarked by a bona fide delivery service on or before September 1 and received at the proper BLM State Office within 15 calendar days after the due date. Payments may also be made by telephone using a credit card. A complete listing of BLM State Offices with their addresses and phone numbers can be found at <http://www.blm.gov>.
- The maintenance fee for the following claim(s)/site(s) applies to the assessment year 2018

CLAIM/SITE NAME	BLM SERIAL NO.
<u>Van Nostrand-McCafferty Mine #1</u>	<u>410-4447</u>
<u>Van Nostrand-McCafferty Mine #2</u>	<u>410-445</u>
<u>Van Nostrand-McCafferty Mine #3</u>	<u>410-446</u>
<u>Van Nostrand-McCafferty Mine #4</u>	<u>410-447</u>
<u>Van Nostrand-McCafferty Mine #5</u>	<u>410-448</u>

Use a separate sheet for additional claim/site names, serial numbers, and claimant names and addresses.

Bluefire Gem LLC.  
P.O. Box 4688  
Tubac, Az 85646

**CERTIFIED MAIL®**



PHOENIX  
AZ 852  
09 AUG '17  
PM 4 L

7016 0910 0001 2771 6950



UNITED STATES POSTAGE  
PITNEY BOWES  
02 1P \$ 006.59<sup>0</sup>  
0000242016 AUG 09 2017  
MAILED FROM ZIP CODE 85646

RECEIVED  
BLM AZ STATE OFFICE

2017 AUG 10 P 2:52

PHOENIX, ARIZONA

BLM  
AZ STATE OFFICE  
ONE NORTH Central Ave st. 800  
Phoenix, Az.  
85004-4427

85004-442700

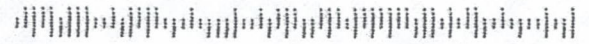

**United States Department of the Interior**  
**Bureau of Land Management**  
 DIV OF LANDS, MINRLS & ENERGY  
 ONE N CENTRAL AVE  
 PHOENIX, AZ 85004 -4427  
 Phone: 602-417-9200

Receipt

No: 3932392

<b>Transaction #:</b> 4041966	
<b>Date of Transaction:</b> 08/11/2017	
CUSTOMER:	
	BLUE FIRE GEM COMPANY LLC PO BOX 4688 TUBAC, AZ 85646-4688 US

LINE #	QTY	DESCRIPTION	REMARKS	UNIT PRICE	TOTAL
1	1.00	LOCATABLE MINERALS / MINING CLAIMS- NOT NEW-UNADJUD, ONE AUTH NO. ONLY / MINING CLAIM MONEY RECEIVED CASES: AMC410431/\$2325.00	MAINT 2018/15	- n/a -	2325.00
<b>TOTAL:</b>					<b>\$2,325.00</b>

PAYMENT INFORMATION					
1	AMOUNT:	2325.00	POSTMARKED:	08/09/2017	
	TYPE:	CHECK	RECEIVED:	08/10/2017	
	CHECK NO:	1209			
	NAME:	BLUE FIRE GEM COMPANY LLC PO BOX 4688 TUBAC AZ 85646-4688 US			

REMARKS

This receipt was generated by the automated BLM Collections and Billing System and is a paper representation of a portion of the official electronic record contained therein.

UNITED STATES  
DEPARTMENT OF THE INTERIOR  
BUREAU OF LAND MANAGEMENT  
**MAINTENANCE FEE PAYMENT FORM FOR  
LODE CLAIMS, MILL SITES, AND TUNNEL SITES**

410427  
413977

Remitter Name: Blue Fire Gem Co. LLC  
Mailing Address: P.O. Box 4688  
City, State, Zip: Tubac, Az, 85646

Check here if this is a change of address.

**FOR COUNTY RECORDER'S USE**

No. of claims/sites 19  
x \$155 per claim/site  
Total due BLM \$ 2945.00

- The maintenance fee may be paid by cash, check, money order, Bureau of Land Management (BLM) Declining Deposit Account, or credit card (VISA, American Express, Discover, or MasterCard). Payments must be remitted to the BLM State Office where your claim or site is recorded and received on or before September 1. If the payment is mailed, the envelope must be postmarked by a bona fide delivery service on or before September 1 and received at the proper BLM State Office within 15 calendar days after the due date. Payments may also be made by telephone using a credit card. A complete listing of BLM State Offices with their addresses and phone numbers can be found at <http://www.blm.gov>.
- The maintenance fee for the following claim(s)/site(s) applies to the assessment year 2017

CLAIM/SITE NAME	BLM SERIAL NO.
CLOSED TO ENTRY #4	410 427
CLOSED TO ENTRY #5	410 428
CLOSED TO ENTRY #6	410 429
CLOSED TO ENTRY #7	410 430
CLOSED TO ENTRY #8	410 431
CLOSED TO ENTRY #9	410 432
CLOSED TO ENTRY #10	410 433
CLOSED TO ENTRY #11	410 434
CLOSED TO ENTRY #12	410 435
CLOSED TO ENTRY #13	410 436

Use a separate sheet for additional claim/site names, serial numbers, and claimant names and addresses.

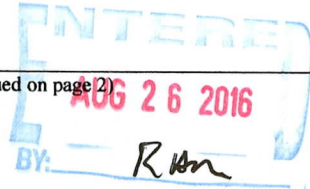
(Continued on page 2)  

PHOENIX ARIZONA  
 2016 AUG 24 P 1:29  
 RECEIVED  
 BLM AZ STATE OFFICE

RECEIPT # 3640680



UNITED STATES  
DEPARTMENT OF THE INTERIOR  
BUREAU OF LAND MANAGEMENT  
MAINTENANCE FEE PAYMENT FORM FOR  
LODE CLAIMS, MILL SITES, AND TUNNEL SITES

Remitter Name: BlueFireGem Co. LLC  
Mailing Address: P.O. Box 4688  
City, State, Zip: Tubac, Az. 85646

Check here if this is a change of address.

FOR COUNTY RECORDER'S USE

No. of claims/sites 19  
x \$155 per claim/site  
Total due BLM \$ \_\_\_\_\_

- The maintenance fee may be paid by cash, check, money order, Bureau of Land Management (BLM) Declining Deposit Account, or credit card (VISA, American Express, Discover, or MasterCard). Payments must be remitted to the BLM State Office where your claim or site is recorded and received on or before September 1. If the payment is mailed, the envelope must be postmarked by a bona fide delivery service on or before September 1 and received at the proper BLM State Office within 15 calendar days after the due date. Payments may also be made by telephone using a credit card. A complete listing of BLM State Offices with their addresses and phone numbers can be found at <http://www.blm.gov>.
- The maintenance fee for the following claim(s)/site(s) applies to the assessment year 2017

CLAIM/SITE NAME	BLM SERIAL NO.
CLOSED TO ENTRY # 14	410 437
CLOSED TO ENTRY # 15	410 438
CLOSED TO ENTRY # 16	<del>410</del> 413 978
CLOSED TO ENTRY # 17	<del>410</del> 413 977
Van Nostrand-M <sup>c</sup> Cafferty Mine #1	410 444
Van Nostrand-M <sup>c</sup> Cafferty Mine #2	410 445
Van Nostrand-M <sup>c</sup> Cafferty Mine #3	410 446
Van Nostrand-M <sup>c</sup> Cafferty Mine #4	410 447
Van Nostrand-M <sup>c</sup> Cafferty Mine #5	410 448
PHOENIX, ARIZONA	

Use a separate sheet for additional claim/site names, serial numbers, and claimant names and addresses.

RECEIVED  
BLM AZ STATE OFFICE  
AUG 24 1:26

Southern Skres Opal  
P.O. Box 4688  
Tubac, Az.

85646

PHOENIX, ARIZONA

AUG 24 P 1:24

PHOENIX, ARIZONA

RETURN RECEIPT  
REQUESTED

CERTIFIED MAIL® PHOENIX



7015 0640 0007 5501 4300

AZ  
22 AL  
PH 91



1000



85004

U.S. POSTAGE  
PAID  
GREEN VALLEY, AZ  
85614  
AUG 22, 16  
AMOUNT

\$6.47

R2304M112163-1

BIM  
AZ STATE OFFICE Suite 800  
ONE NORTH Central Ave.  
Phoenix, Az.  
85004-4427

8500484427 C041



Southern Skies Opal  
P.O. Box 4688  
Tubac, Az.

CERTIFIED MAIL



7015 0640 0007 5501 4300



1000

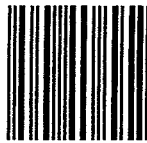

85004

U.S. POSTAGE  
PAID  
GREEN VALLEY, AZ  
85614  
AUG 22 16  
AMOUNT

\$6.47

R2304M112163-1

RECEIVED  
AUG 24 P 1:26  
PHOENIX, ARIZONA  
AZ STATE OFFICE  
RETURNED TO SENDER  
REQUIRE POSTAGE

BIM  
AZ STATE OFFICE Suite 800  
ONE NORTH Central Ave.  
Phoenix, Az. 85004-4427

8500434427 CD41

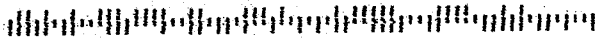

**United States Department of the Interior**  
**Bureau of Land Management**  
 DIV OF LANDS, MINRLS & ENERGY  
 ONE N CENTRAL AVE  
 PHOENIX, AZ 85004 -4427  
 Phone: 602-417-9200

Receipt

No: 3640680

<b>Transaction #:</b> 3744625	
<b>Date of Transaction:</b> 08/25/2016	
CUSTOMER:	
BLUE FIRE GEM COMPANY LLC PO BOX 4688 TUBAC, AZ 85646-4688 US	

LINE #	QTY	DESCRIPTION	REMARKS	UNIT PRICE	TOTAL
1	1.00	LOCATABLE MINERALS / MINING CLAIMS- NOT NEW-UNADJUD, ONE AUTH NO. ONLY / MINING CLAIM MONEY RECEIVED CASES: AMC410427/\$2945.00	MAINT FEE 2017 - 19	- n/a -	2945.00
<b>TOTAL:</b>					<b>\$2,945.00</b>

PAYMENT INFORMATION			
1	AMOUNT:	2945.00	POSTMARKED: 08/22/2016
	TYPE:	CHECK	RECEIVED: 08/24/2016
	CHECK NO:	2217	
	NAME:	SOUTHERN SKIES OPAL LLC PO BOX 1916 TUBAC AZ 85646-4688 US	

REMARKS

This receipt was generated by the automated BLM Collections and Billing System and is a paper representation of a portion of the official electronic record contained therein.

UNITED STATES  
DEPARTMENT OF THE INTERIOR  
BUREAU OF LAND MANAGEMENT  
**MAINTENANCE FEE PAYMENT FORM FOR  
LODE CLAIMS, MILL SITES, AND TUNNEL SITES**

410427  
413977

Remitter Name: Blue Fire Gem Co. LLC.  
Mailing Address: P.O. Box 4688  
City, State, Zip: Tubac, Az. 85646

Check here if this is a change of address.

**FOR COUNTY RECORDER'S USE**

No. of claims/sites 19  
x \$155 per claim/site  
Total due BLM \$ 2945<sup>00</sup>

- The maintenance fee may be paid by cash, check, money order, Bureau of Land Management (BLM) Declining Deposit Account, or credit card (VISA, American Express, Discover, or MasterCard). Payments must be remitted to the BLM State Office where your claim or site is recorded and received on or before September 1. If the payment is mailed, the envelope must be postmarked by a bona fide delivery service on or before September 1 and received at the proper BLM State Office within 15 calendar days after the due date. Payments may also be made by telephone using a credit card. A complete listing of BLM State Offices with their addresses and phone numbers can be found at <http://www.blm.gov>.
- The maintenance fee for the following claim(s)/site(s) applies to the assessment year 2016.

CLAIM/SITE NAME	BLM SERIAL NO.
CLOSED to entry #4	410427
CLOSED to entry #5	416428
CLOSED to entry #6	410429
closed to entry #7	410430
closed to entry #8	410431
closed to entry #9	410432
closed to entry #10	410433
closed to entry #11	410434
closed to entry #12	410435
closed to entry #13	410436

RECEIVED  
BLM STATE OFFICE  
2015 AUG 25 P 2 23  
ARIZONA

Use a separate sheet for additional claim/site names, serial numbers, and claimant names and addresses.

(Continued on page 2)

ENTERED  
AUG 23 2015  
BY: RE

RECEIPT # 3377583

UNITED STATES  
DEPARTMENT OF THE INTERIOR  
BUREAU OF LAND MANAGEMENT  
**MAINTENANCE FEE PAYMENT FORM FOR  
LODE CLAIMS, MILL SITES, AND TUNNEL SITES**

Remitter Name: \_\_\_\_\_

Mailing Address: \_\_\_\_\_

City, State, Zip: \_\_\_\_\_

Check here if this is a change of address.

**FOR COUNTY RECORDER'S USE**

No. of claims/sites \_\_\_\_\_  
x \$155 per claim/site  
Total due BLM \$ \_\_\_\_\_

- The maintenance fee may be paid by cash, check, money order, Bureau of Land Management (BLM) Declining Deposit Account, or credit card (VISA, American Express, Discover, or MasterCard). Payments must be remitted to the BLM State Office where your claim or site is recorded and received on or before September 1. If the payment is mailed, the envelope must be postmarked by a bona fide delivery service on or before September 1 and received at the proper BLM State Office within 15 calendar days after the due date. Payments may also be made by telephone using a credit card. A complete listing of BLM State Offices with their addresses and phone numbers can be found at <http://www.blm.gov>.
- The maintenance fee for the following claim(s)/site(s) applies to the assessment year 2016.

CLAIM/SITE NAME	BLM SERIAL NO.
CLOSED TO ENTRY # 14	410 437
CLOSED TO Entry # 15	410 438
Closed To Entry # 16	413 978
Closed To Entry # 17	413 977
VAN Nostrand-McCafferty Mine # 1	410 444
VAN Nostrand-McCafferty Mine # 2	410 445
VAN Nostrand-McCafferty Mine # 3	410 446
VAN Nostrand-McCafferty Mine # 4	410 447
VAN Nostrand-McCafferty Mine # 5	410 448

Use a separate sheet for additional claim/site names, serial numbers, and claimant names and addresses.

RECEIVED  
 BLM STATE OFFICE  
 PHOENIX, ARIZONA  
 2015 AUG 25 P 2:23

Blue Fire Gem Co  
PO Box 4688

Tubac AZ 85646

RECEIVED  
BEM AZ STATE OFFICE

2015 AUG 25 P 2:07

PHOENIX, ARIZONA

PHOENIX AZ 852

20 AUG 2015 PM 9 L



Bureau of Land Management  
One North Central Ave, Ste 800  
Phoenix AZ 85004-4427

85004442700



Blue Fire Gem Co

PO Box 4688

Tubac AZ

85646

RECEIVED  
BEM AZ STATE OFFICE

2015 AUG 25 P 2:07

PHOENIX, ARIZONA

PHOENIX AZ 852

20 AUG 2015 PM 9 L



Bureau of Land Management  
One North Central Ave, Ste 800  
Phoenix AZ 85004-4427

85004442700

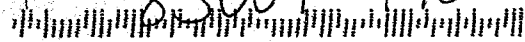



**United States Department of the Interior**  
**Bureau of Land Management**  
LANDS/RECREATION & PLANNING  
ONE N CENTRAL AVE  
PHOENIX, AZ 85004 -2203  
Phone: 602-417-9200

Receipt

No: 3377583

<b>Transaction #:</b> 3475832	
<b>Date of Transaction:</b> 08/26/2015	
<b>CUSTOMER:</b>	
BLUE FIRE GEM COMPANY LLC PO BOX 4688 TUBAC, AZ 85646-4688 US	

LINE #	QTY	DESCRIPTION	REMARKS	UNIT PRICE	TOTAL
1	1.00	LOCATABLE MINERALS / MINING CLAIMS-NOT NEW-UNADJUD, ONE AUTH NO. ONLY / MINING CLAIM MONEY RECEIVED CASES: AMC410427/\$2945.00	MANIT FEE PYMNT - 19 2016	- n/a -	2945.00
<b>TOTAL:</b>					<b>\$2,945.00</b>

PAYMENT INFORMATION			
1	AMOUNT:	2945.00	POSTMARKED: 08/19/2015
	TYPE:	CHECK	RECEIVED: 08/25/2015
	CHECK NO:	1205	
	NAME:	BLUE FIRE GEM COMPANY LLC PO BOX 4688 TUBAC AZ 85646-4688 US	

REMARKS

This receipt was generated by the automated BLM Collections and Billing System and is a paper representation of a portion of the official electronic record contained therein.

UNITED STATES  
DEPARTMENT OF THE INTERIOR  
BUREAU OF LAND MANAGEMENT  
**MAINTENANCE FEE PAYMENT FORM FOR  
LODE CLAIMS, MILL SITES, AND TUNNEL SITES**

410427  
413977

Remitter Name: Blue Fire Gem Co, LLC.  
Mailing Address: P.O. Box 4688  
City, State, Zip: Tubac, Az. 85646

Check here if this is a change of address.

**FOR COUNTY RECORDER'S USE**

No. of claims/sites 19  
x \$155 per claim/site  
Total due BLM \$ 2945.<sup>00</sup>

- The maintenance fee may be paid by cash, check, money order, Bureau of Land Management (BLM) Declining Deposit Account, or credit card (VISA, American Express, Discover, or MasterCard). Payments must be remitted to the BLM State Office where your claim or site is recorded and received on or before September 1. If the payment is mailed, the envelope must be postmarked by a bona fide delivery service on or before September 1 and received at the proper BLM State Office within 15 calendar days after the due date. Payments may also be made by telephone using a credit card. A complete listing of BLM State Offices with their addresses and phone numbers can be found at <http://www.blm.gov>.
- The maintenance fee for the following claim(s)/site(s) applies to the assessment year 2015.

CLAIM/SITE NAME	BLM SERIAL NO.
CLOSED TO ENTRY # 4	410 427
CLOSED TO ENTRY # 5	410 428
CLOSED TO ENTRY # 6	410 429
CLOSED TO ENTRY # 7	410 430
CLOSED TO ENTRY # 8	410 431
CLOSED TO ENTRY # 9	410 432
CLOSED TO ENTRY # 10	410 433
CLOSED TO ENTRY # 11	410 434
CLOSED TO ENTRY # 12	410 435
CLOSED TO ENTRY # 13	410 436

Use a separate sheet for additional claim/site names, serial numbers, and claimant names and addresses.

(Continued on page 2)

**ENTERED**  
AUG 28 2014  
*[Signature]*

RECEIPT # 3112528

RECEIVED  
BLM AZ STATE OFFICE  
TUBAC, ARIZONA  
AUG 25 P 2:10

UNITED STATES  
DEPARTMENT OF THE INTERIOR  
BUREAU OF LAND MANAGEMENT  
**MAINTENANCE FEE PAYMENT FORM FOR  
LODE CLAIMS, MILL SITES, AND TUNNEL SITES**

Remitter Name: Blue Fire Gem Co. LLC.

Mailing Address: P.O. Box 4688

City, State, Zip: Tubac, Az. 85646

Check here if this is a change of address.

**FOR COUNTY RECORDER'S USE**

No. of claims/sites 19  
x \$155 per claim/site  
Total due BLM \$ 2945<sup>00</sup>

- The maintenance fee may be paid by cash, check, money order, Bureau of Land Management (BLM) Declining Deposit Account, or credit card (VISA, American Express, Discover, or MasterCard). Payments must be remitted to the BLM State Office where your claim or site is recorded and received on or before September 1. If the payment is mailed, the envelope must be postmarked by a bona fide delivery service on or before September 1 and received at the proper BLM State Office within 15 calendar days after the due date. Payments may also be made by telephone using a credit card. A complete listing of BLM State Offices with their addresses and phone numbers can be found at <http://www.blm.gov>.
- The maintenance fee for the following claim(s)/site(s) applies to the assessment year 2014.

CLAIM/SITE NAME	BLM SERIAL NO.
CLOSED TO Entry #14	410 437
CLOSED TO Entry #15	<u>410 438</u>
CLOSED TO Entry #16	413 978
CLOSED TO Entry #17	<u>413 977</u>
Van Nostrand-McCafferty Mine # 1	410 444
Van Nostrand-McCafferty Mine # 2	410 445
Van Nostrand-McCafferty Mine # 3	410 446
Van Nostrand-McCafferty Mine # 4	410 447
Van Nostrand-McCafferty Mine # 5	410 448

Use a separate sheet for additional claim/site names, serial numbers, and claimant names and addresses.

(Continued on page 2)

RECEIVED  
 BLM ARIZONA STATE OFFICE  
 2014 AUG 25 P 2:10  
 PHOENIX, ARIZONA

Blue Fire Gem Co, LLC,  
P.O. Box 4688  
Tubac, Az, 85646

RECEIVED  
BLM AZ STATE OFFICE

2014 AUG 25 P 2:10

PHOENIX, ARIZONA

Bureau of Land Management  
ARIZONA State Office  
One N. Central Avenue  
Phoenix, Az.

85004-2203

8500494414

CERTIFIED MAIL™



7013 3020 0001 7912 6288

PHOENIX AZ 852

22 AUG 2014 PM 5 L



CERTIFIED MAIL™

BlueFire Gem Co, LLC  
P.O. Box 4688  
Tubac, Az. 85646



PHOENIX AZ 852

22 AUG 2014 PM 5 L

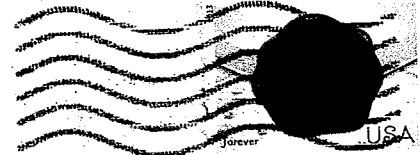

RECEIVED  
BLM AZ STATE OFFICE

7013 3020 0001 7912 6288

2014 AUG 25 P 2:10

PHOENIX, ARIZONA

Bureau of Land Management  
ARIZONA State Office  
One N. Central Avenue  
Phoenix, Az.

85004-2203

8500434414

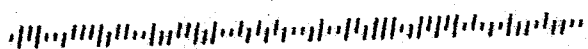

**United States Department of the Interior**  
**Bureau of Land Management**  
 LANDS/RECREATION & PLANNING  
 ONE N CENTRAL AVE  
 PHOENIX, AZ 85004 -2203  
 Phone: 602-417-9200

Receipt

No: 3112528

<b>Transaction #:</b> 3204242	
<b>Date of Transaction:</b> 08/26/2014	
<b>CUSTOMER:</b>	
BLUE FIRE GEM COMPANY LLC PO BOX 4688 TUBAC, AZ 85646-4688 US	

LINE #	QTY	DESCRIPTION	REMARKS	UNIT PRICE	TOTAL
1	1.00	LOCATABLE MINERALS / MINING CLAIMS-NOT NEW-UNADJUD, ONE AUTH NO. ONLY / MINING CLAIM MONEY RECEIVED CASES: AMC410427/\$2945.00	MAINT FEE PYMNT (19) 2015	- n/a -	2945.00
<b>TOTAL:</b>					<b>\$2,945.00</b>

PAYMENT INFORMATION					
1	AMOUNT:	2945.00	POSTMARKED:	08/22/2014	
	TYPE:	CHECK	RECEIVED:	08/25/2014	
	CHECK NO:	1196			
	NAME:	BLUE FIRE GEM COMPANY LLC PO BOX 1916 TUBAC AZ 85646-4688 US			

<b>REMARKS</b>

This receipt was generated by the automated BLM Collections and Billing System and is a paper representation of a portion of the official electronic record contained therein.

**NOTICE!!**

**These documents have been scanned!**

**Do not place un-scanned documents beneath this notice!**

**Do not remove this notice from this file!**

GPO Jacket No. 560-102  
Print Order 61540  
Rise Business Services, LLC  
Job=AZ15 5/16/2019



Box Number= AZ15056



Claim Begin-End: AMC410427-AMC410448

6 Location Notices-Amendments and Supporting Documents



AZ15056-17

AMC409378-AMC410492

# MINING CLAIM STATUS REPORT

DATA ENTERED SEP 17 2011 *u*

MTP Checked by *M*  
 GEO Checked by *M*

LEAD SERIAL NUMBER AMC 410427 thru AMC 410448

**# OF CLAIMS & TYPE**

# 22 LODE  
 # \_\_\_\_\_ PLACER  
 # \_\_\_\_\_ ASSOCIATION PLACER  
 # \_\_\_\_\_ MILL SITE  
 # \_\_\_\_\_ TUNNEL SITE

**CHARGES**

Location Fee @ \$34 = \$ 748  
 Processing Fee @ \$15 = \$ 330  
 Maintenance Fee @ \$140 = \$ 3,080  
 Overage (+) \$ \_\_\_\_\_  
 Shortage (-) \$ \_\_\_\_\_  
 Other Fees \$ \_\_\_\_\_  
**TOTAL \$ 4,158**

ARE THERE ENOUGH LOCATORS?

Yes ( ) No ( ) \_\_\_\_\_

DOCUMENTS RECEIVED VIA -

Over-the-Counter ( ) Mail ()

TIMELY FILED?

Yes () No ( )

*accepted as mail*

LEGAL DESCRIPTION -	T	<u>225</u>	R	<u>11E</u>	SEC	<u>20, 25, 27</u>
	T	<u>215</u>	R	<u>10E</u>	SEC	<u>7, 18</u>
	T	_____	R	_____	SEC	_____
	T	_____	R	_____	SEC	_____

BLM ( ) FOREST SERVICE () Coronado SUBJ TO PL 359: Yes ( ) No ( )

WILDERNESS AREA: No ( ) Yes ( ) \_\_\_\_\_

SPLIT ESTATE - N/A ( ) SX ( ) PX ( ) SRHA ( ) OTHER ( ) \_\_\_\_\_

Proper Notice Filed if Located on SHRA Lands? N/A ( ) Yes ( ) No ( )

RECONVEYED MINERALS ON BLM LANDS REQUIRE OPENING ORDERS FROM 1944 TO 1993 -

Open to Entry on: \_\_\_\_\_ N/A ( )

COMMENTS/STATUS - VOID ( ) PARTIALLY VOID ( ) PVT MINERALS ( ) WITHDRAWN LANDS ( )

OTHER ( ) ~~410427, 410447 (voided) [unclear]~~  
~~410428, 410448 [unclear]~~

Claimant acknowledges that portions of the following claims(s) site(s) may be void or voidable.

Printed Name of Claimant \_\_\_\_\_ Signature of Claimant \_\_\_\_\_

\*\*\*\*\* FINAL ADJUDICATION \*\*\*\*\*

DATE 4/2/2012 INITIALS *TS*

AMC410427



LOCATION NOTICE FOR LODE MINING CLAIM

NOTICE IS HEREBY GIVEN that the CLOSED TO ENTRY\*4

\_\_\_\_\_ lode mining claim has been located

by Bluefire Gem Co. LLC, whose current mailing

address is P.O. Box 1916

Tubac, Az. 85646

RECEIVED  
BLM, AZ STATE OFFICE  
2011 SEP -6 A 11: 13  
PHOENIX, AZ  
BLM  
Date  
Stamp

The general course of this claim is NorthEast and it is situated in Santa Cruz

County, Arizona. This claim is 1,500 feet in length and 600 feet in width. This claim runs

from the location monument on which this location notice is posted approximately 750 feet in a

SW direction to the South end line and 750 feet in a N.E. direction to the

N end line. This claim is marked by six monuments, one at each corner and one at the center of each end line of the claim.

The location monument on which this notice is posted is situated within Section 20, Township 22 South

\_\_\_\_\_, Range 11 E, Gila Salt River Base and Meridian, Arizona and this claim encompasses portions

of the following quarter section (s), section (s), Township (s) and Range (s) NW and NE 1/4's Sec. 20,

T 22 S, R 11 E

Gila Salt River Base and Meridian, Arizona.

The locality of this claim with reference to some natural object or permanent monument and additional information

(if any) concerning its locality are as follows: 1 mile north of Papago Tanks

DATED AND POSTED on the ground this 15<sup>th</sup> day of September, 2011.

LOCATOR (s) Bluefire Gem Co. LLC

Agent - Vincent Galindo

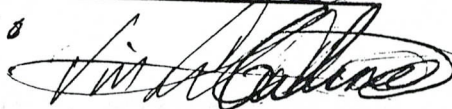

Form MCF100  
Revised July 2005

AMC 410427

**MINING CLAIM MAP**

Lode  Placer ( )

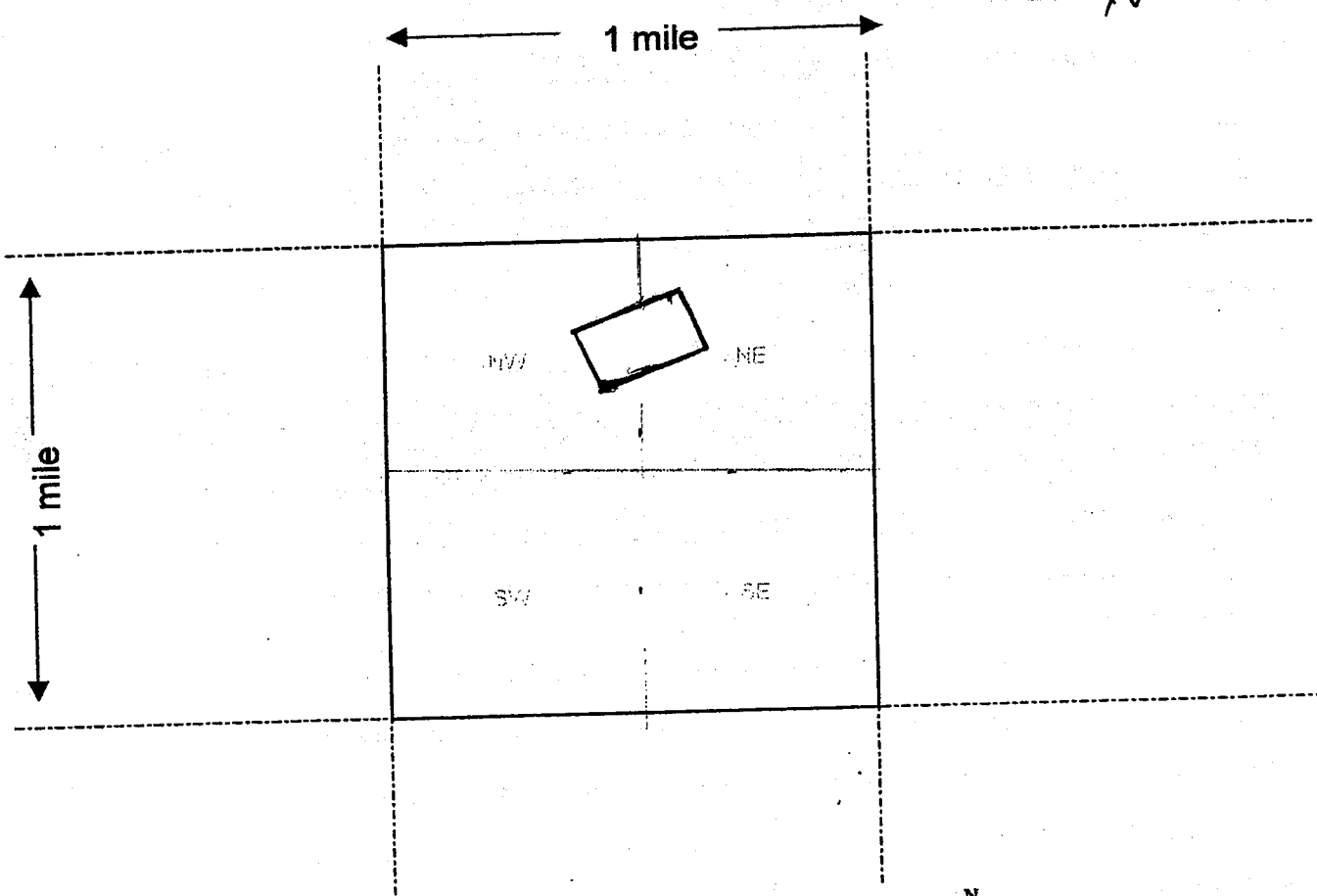

Scale : 1" = 2000 feet

1. The above map depicts the Closed to entry #4 mining claim, which is located in Section (s) 20, Township 22 S, Range 11 E, Gila and Salt River Base and Meridian, SANTA CRUZ County, Arizona.

2. The type of corner and location monuments used are as follows: Post & stone

3. The bearings and distances in degrees and feet between claim corners are as depicted on the map.

Form MCF100a  
Revised July 2005

LOCATION NOTICE FOR LODE MINING CLAIM

NOTICE IS HEREBY GIVEN that the CLOSED TO ENTRY #5  
\_\_\_\_\_ lode mining claim has been located  
by Bluefire Gem Co. LLC, whose current mailing  
address is P.O. Box 1916  
Tubac, Az. 85646

RECEIVED  
BLM, AZ STATE OFFICE  
2011 SEP -6 A 11: 13  
PHOENIX, AZ  
BLM  
Date  
Stamp

The general course of this claim is NORTHEAST and it is situated in SANTA CRUZ  
County, Arizona. This claim is 1,500 feet in length and 600 feet in width. This claim runs  
from the location monument on which this location notice is posted approximately 750 feet in a  
SW direction to the SOUTH end line and 750 feet in a NE direction to the  
NORTH end line. This claim is marked by six monuments, one at each corner and one at the center of each  
end line of the claim.

The location monument on which this notice is posted is situated within Section 20, Township 22 South  
11 EAST, Gila Salt River Base and Meridian, Arizona and this claim encompasses portions  
of the following quarter section (s), section (s), Township (s) and Range (s) NE 1/4, Sec. 20  
T 22 S, R 11 E

Gila Salt River Base and Meridian, Arizona.

The locality of this claim with reference to some natural object or permanent monument and additional information  
(if any) concerning its locality are as follows: 1 mile north of Papago Tanks

DATED AND POSTED on the ground this 1st day of September, 2011.

LOCATOR (s) Bluefire Gem Co. LLC  
Agent - Vincent Pulino

Form MCF100  
Revised July 2005

AMC410428

**MINING CLAIM MAP**

Lode (X) Placer ( )

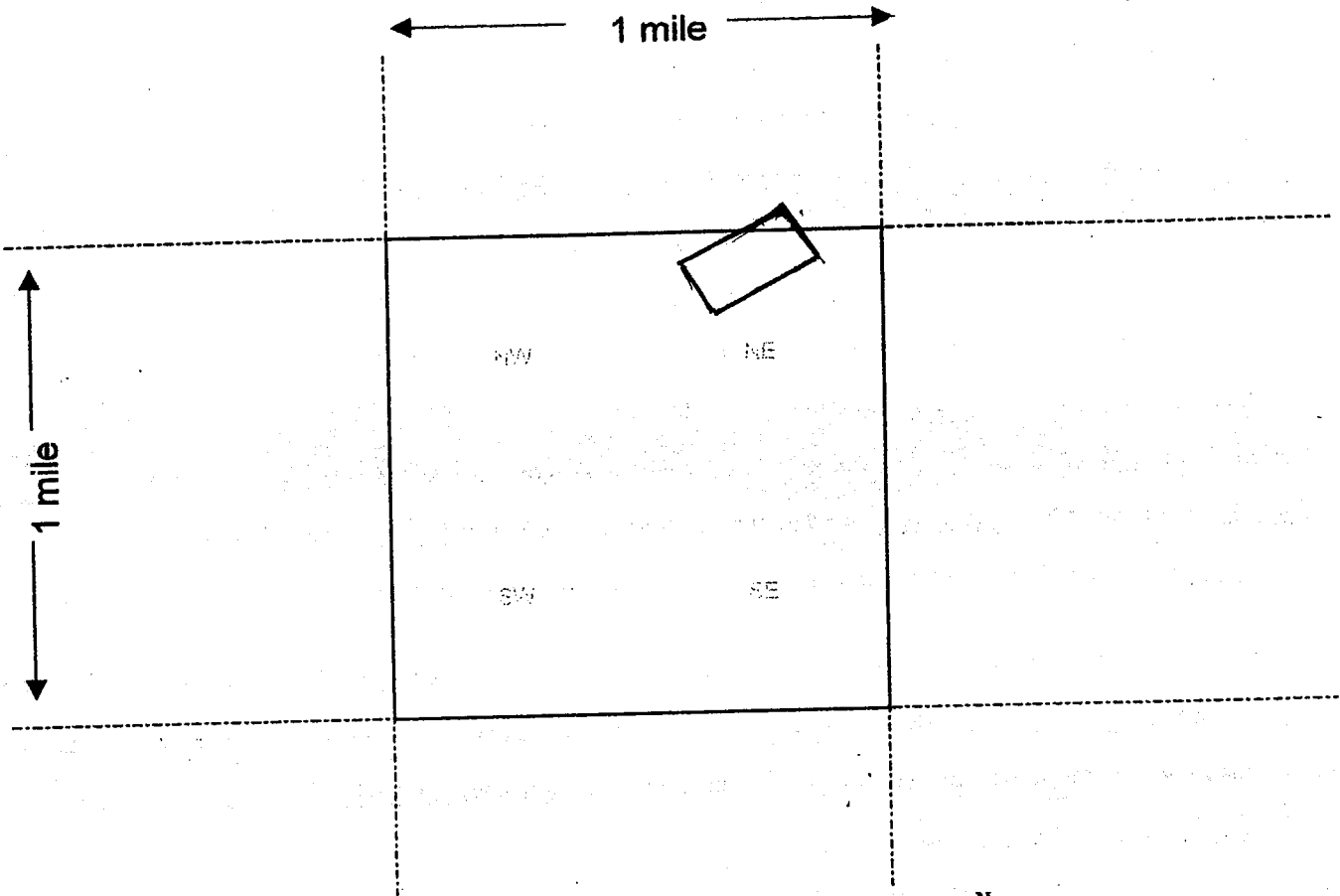

Scale : 1" = 2000 feet



1. The above map depicts the Closed To Entry # 5 mining claim, which is located in Section (s) 20, Township 22 S, Range 11 E, Gila and Salt River Base and Meridian,

SANTA CRUZ County, Arizona.

2. The type of corner and location monuments used are as follows: post And stone

3. The bearings and distances in degrees and feet between claim corners are as depicted on the map.

Form MCF100a  
Revised July 2005

LOCATION NOTICE FOR LODE MINING CLAIM

NOTICE IS HEREBY GIVEN that the CLOSED TO ENTRY #6  
\_\_\_\_\_ lode mining claim has been located  
by Bluefire Gem Co. LLC whose current mailing  
address is P.O. Box 1916  
Tubac, AZ. 85646

RECEIVED  
B.L.M. AZ STATE OFFICE  
2011 SEP -6 A 11: 13  
PHOENIX, AZ  
BLM  
Date  
Stamp

The general course of this claim is Northeast and it is situated in Santa Cruz  
County, Arizona. This claim is 1,500 feet in length and 600 feet in width. This claim runs  
from the location monument on which this location notice is posted approximately 750 feet in a  
SW direction to the SOUTH end line and 750 feet in a NE direction to the  
NORTH end line. This claim is marked by six monuments, one at each corner and one at the center of each  
end line of the claim.

The location monument on which this notice is posted is situated within Section 20, Township 22 south  
\_\_\_\_\_, Range 11 E, Gila Salt River Base and Meridian, Arizona and this claim encompasses portions  
of the following quarter section (s), section (s), Township (s) and Range (s) NE 1/4, SEC 20,  
T 22 S, R 11 E

Gila Salt River Base and Meridian, Arizona.

The locality of this claim with reference to some natural object or permanent monument and additional information  
(if any) concerning its locality are as follows: 1 mile north of Papago Tanks

DATED AND POSTED on the ground this 1st day of September 20 11.

LOCATOR (s) Bluefire Gem Co., LLC.

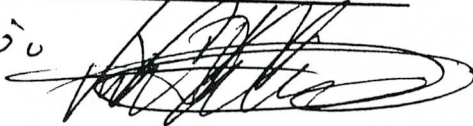
Agent - Vincent Gulino 

Form MCF100  
Revised July 2005

AMC410429

**MINING CLAIM MAP**

Lode (X) Placer ( )

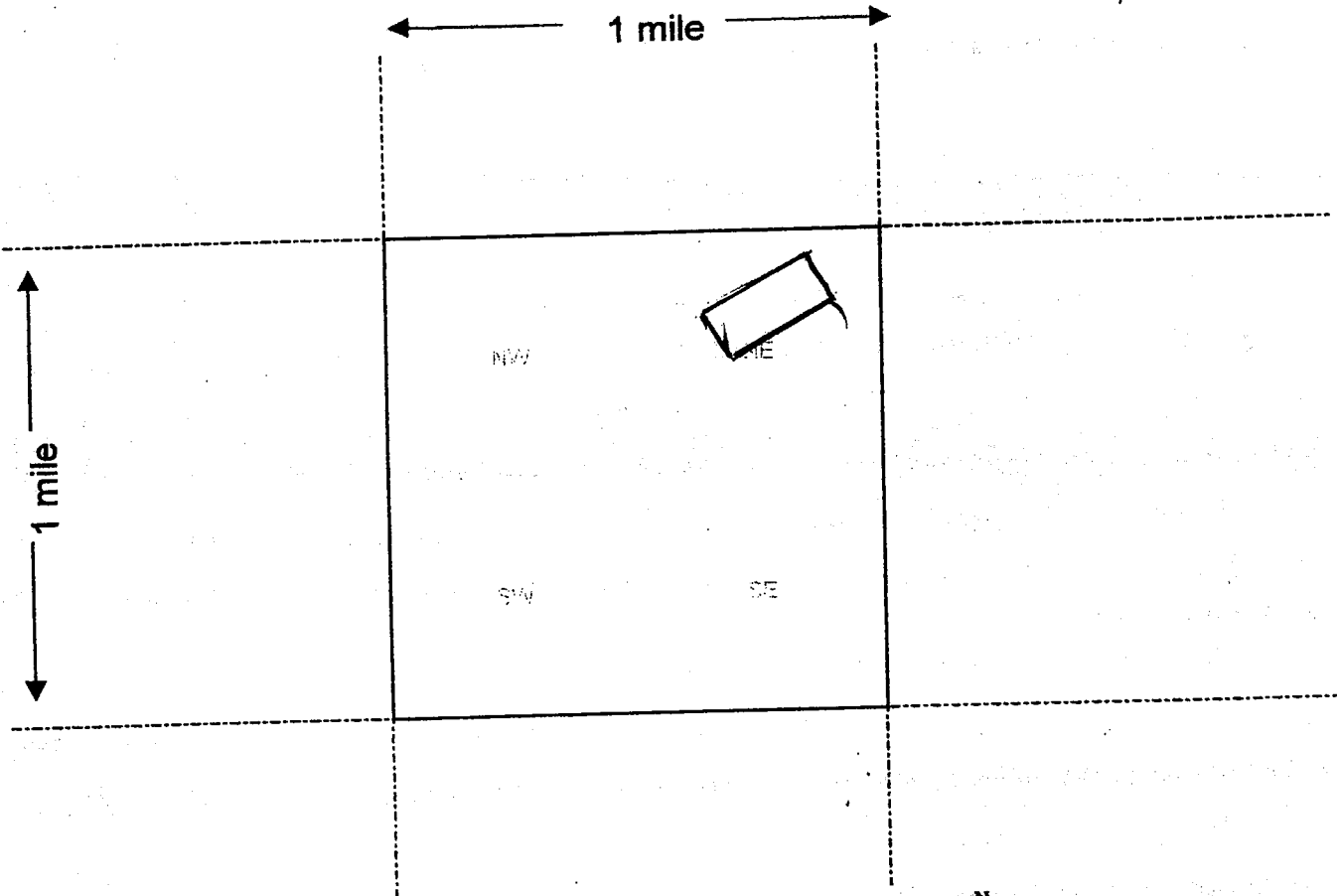

Scale : 1" = 2000 feet

1. The above map depicts the CLOSED TO ENTRY #6 mining claim, which is located in Section (s) 20, Township 22 SOUTH Range 11 E, Gila and Salt River Base and Meridian,

SANTA CRUZ County, Arizona.

2. The type of corner and location monuments used are as follows: Post + Stone

3. The bearings and distances in degrees and feet between claim corners are as depicted on the map.

Form MCF100a  
Revised July 2005

This form is available from the Arizona Department of Mines & Mineral Resources and may be reproduced.

LOCATION NOTICE FOR LODE MINING CLAIM

NOTICE IS HEREBY GIVEN that the CLOSED TO ENTRY #7  
lode mining claim has been located  
by Bluefire Gem Co. LLC, whose current mailing  
address is P.O. Box 1916  
Tubac, Az. 85646

RECEIVED  
BLM, AZ STATE OFFICE  
2011 SEP - 6 A 11: 13  
PHOENIX, AZ  
BLM  
Date  
Stamp

The general course of this claim is NORTH EAST and it is situated in SANTA CRUZ  
County, Arizona. This claim is 1,500 feet in length and 600 feet in width. This claim runs  
from the location monument on which this location notice is posted approximately 750 feet in a  
SW direction to the south end line and 750 feet in a NE direction to the  
NORTH end line. This claim is marked by six monuments, one at each corner and one at the center of each  
end line of the claim.

The location monument on which this notice is posted is situated within Section 20, Township 22 south  
11 East, Gila Salt River Base and Meridian, Arizona and this claim encompasses portions  
of the following quarter section (s), section (s), Township (s) and Range (s) NE 1/4, SEC 20  
T 22 S, R 11 E

Gila Salt River Base and Meridian, Arizona.

The locality of this claim with reference to some natural object or permanent monument and additional information  
(if any) concerning its locality are as follows: 1 mile north of Papago Tanks

AMC410430

DATED AND POSTED on the ground this 1st day of September, 20 11.

LOCATOR (s) Bluefire Gem Co. LLC

Agent - Vincent Pulido

Form MCF100  
Revised July 2005

**MINING CLAIM MAP**

Lode (X) Placer ( )

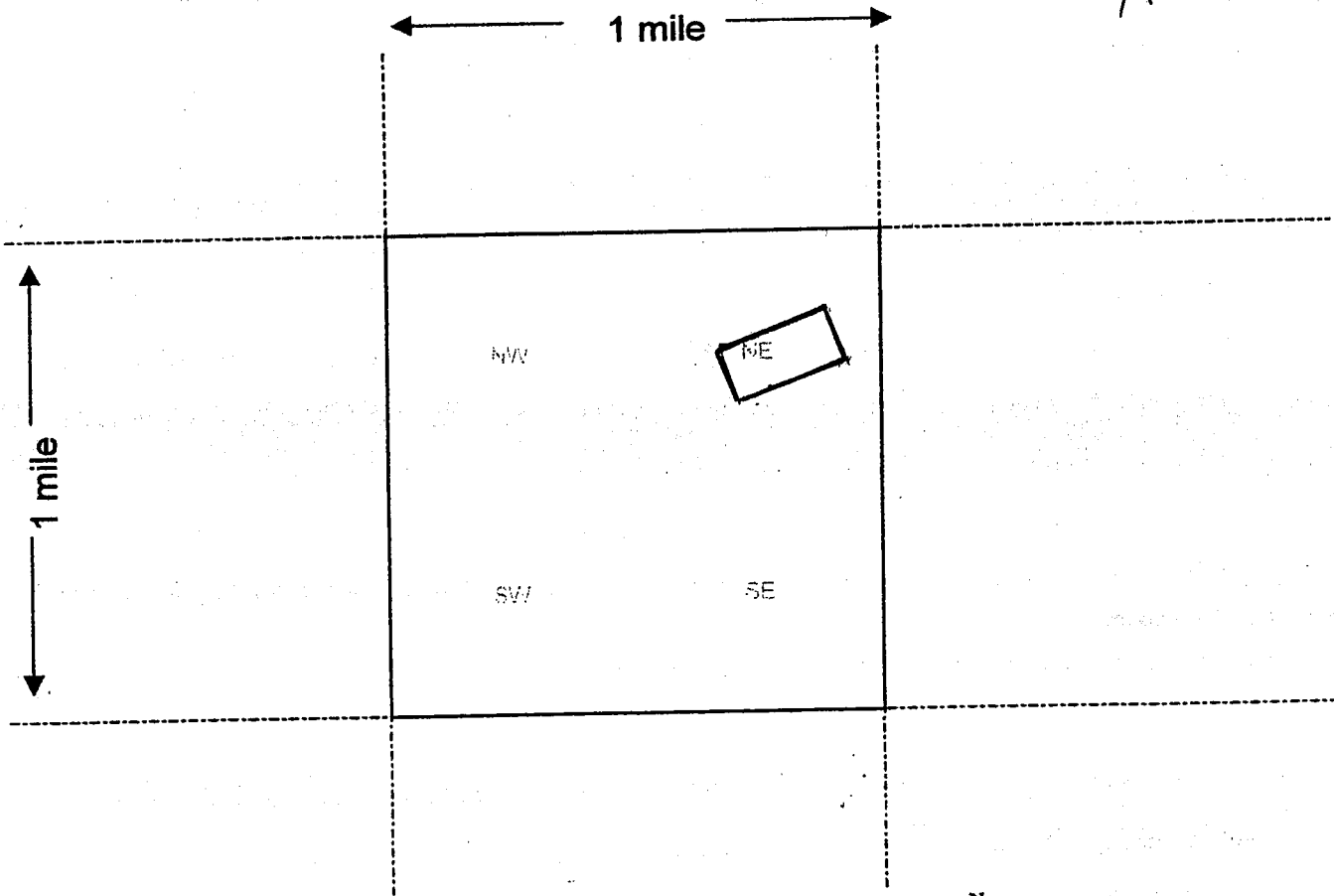

Scale : 1" = 2000 feet



1. The above map depicts the CLOSED TO ENTRY #7 mining claim, which is located in Section (s) 20, Township 22 S, Range 11 E, Gila and Salt River Base and Meridian, SANTA CRUZ County, Arizona.

2. The type of corner and location monuments used are as follows: post + stone

3. The bearings and distances in degrees and feet between claim corners are as depicted on the map.

Form MCF100a  
Revised July 2005



RECEIVED  
B.L.M. AZ STATE OFFICE

2011 SEP - 6 A 11: 13

PHOENIX, AZ

BLM  
Date  
Stamp

**LOCATION NOTICE FOR LODE MINING CLAIM**

NOTICE IS HEREBY GIVEN that the Closed to Entry # 8  
\_\_\_\_\_ lode mining claim has been located  
by Bluefire Gem Co, LLC whose current mailing  
address is P.O. Box 1916  
Tubac, AZ, 85646

The general course of this claim is West to East and it is situated in SANTA CRUZ  
County, Arizona. This claim is 1,500 feet in length and 600 feet in width. This claim runs  
from the location monument on which this location notice is posted approximately 750 feet in a  
due west direction to the WEST end line and 750 feet in a due east direction to the  
EAST end line. This claim is marked by six monuments, one at each corner and one at the center of each  
end line of the claim.

The location monument on which this notice is posted is situated within Section 25, Township 22 South  
\_\_\_\_\_, Range 11 East, Gila Salt River Base and Meridian, Arizona and this claim encompasses portions  
of the following quarter section (s), section (s), Township (s) and Range (s) SE 1/4, S 25, T 22 S,  
R 11 E And SW 1/4, S 25, T 22 S, R 11 E  
Gila Salt River Base and Meridian, Arizona.

The locality of this claim with reference to some natural object or permanent monument and additional information  
(if any) concerning its locality are as follows: 7,000 feet in a northerly direction  
from Javelina DAM.

DATED AND POSTED on the ground this 1st day of September, 20 11.

LOCATOR (s) Bluefire Gem LLC

Agent - Vincent Guliño

Form MCF100  
Revised July 2005

AMC410431

**MINING CLAIM MAP**

Lode (X) Placer ( )

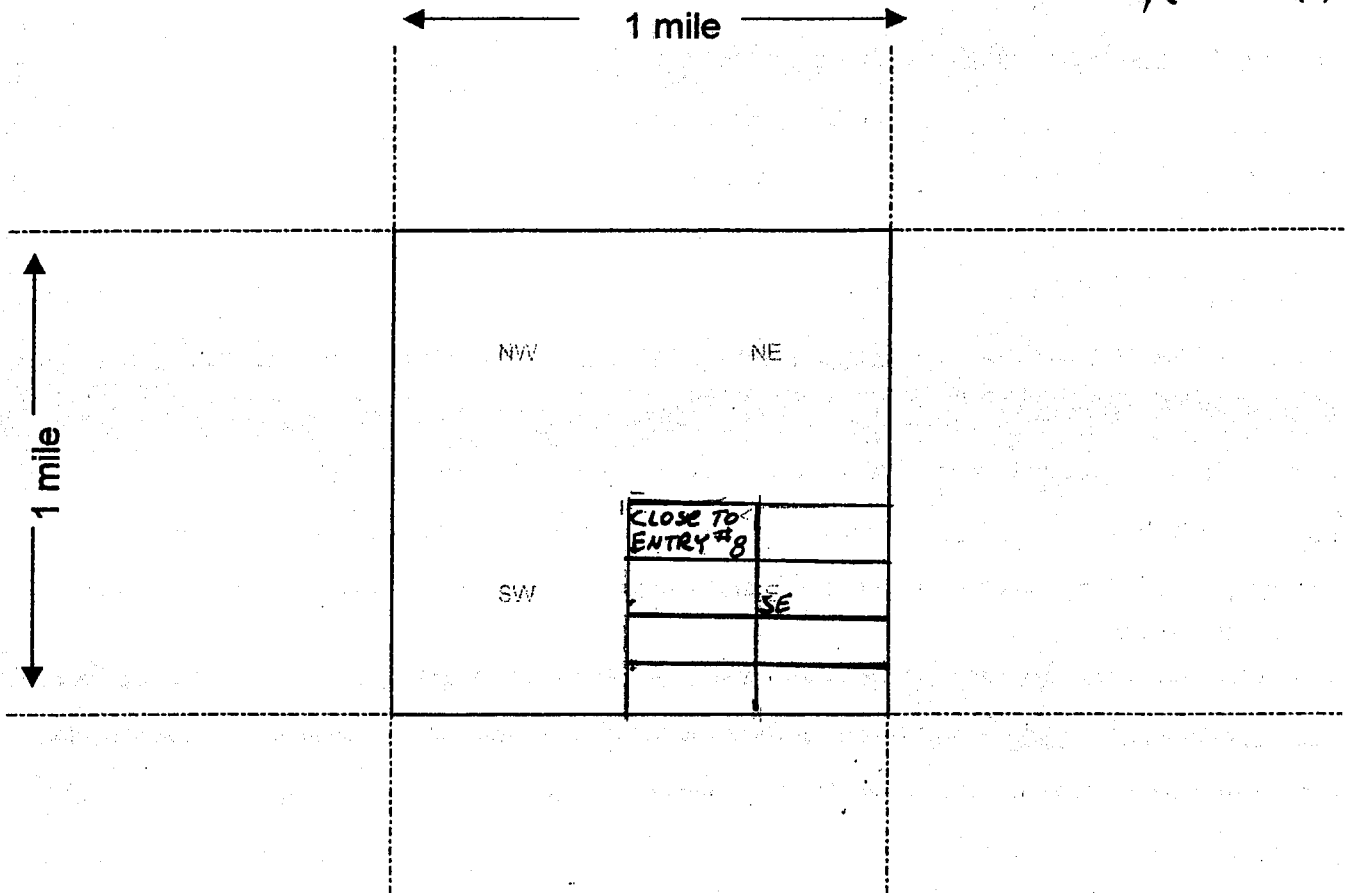

Scale : 1" = 2000 feet



1. The above map depicts the CLOSE TO ENTRY #8 mining claim, which is located in Section (s) 25, Township 22 South, Range 11 East, Gila and Salt River Base and Meridian, \_\_\_\_\_ County, Arizona.

2. The type of corner and location monuments used are as follows: STONE AND POST

3. The bearings and distances in degrees and feet between claim corners are as depicted on the map.

Form MCF100a  
Revised July 2005

LOCATION NOTICE FOR LODE MINING CLAIM

NOTICE IS HEREBY GIVEN that the CLOSED TO ENTRY #9  
\_\_\_\_\_ lode mining claim has been located  
by Bluefire Gem Co, LLC whose current mailing  
address is P.O. Box 1916,  
Tubac, AZ. 85646

RECEIVED  
BLM, AZ STATE OFFICE  
2011 SEP - 6 A 11:13  
PHOENIX, AZ  
BLM  
Date  
Stamp

The general course of this claim is WEST TO EAST and it is situated in SANTA CRUZ  
County, Arizona. This claim is 1,500 feet in length and 600 feet in width. This claim runs  
from the location monument on which this location notice is posted approximately 750 feet in a  
due west direction to the WEST end line and 750 feet in a due east direction to the  
EAST end line. This claim is marked by six monuments, one at each corner and one at the center of each  
end line of the claim.

The location monument on which this notice is posted is situated within Section 25, Township 22 South  
\_\_\_\_\_, Range 11 EAST, Gila Salt River Base and Meridian, Arizona and this claim encompasses portions  
of the following quarter section (s), section (s), Township (s) and Range (s) SE 1/4, Sec 25, T 22S,  
R 11 E.

Gila Salt River Base and Meridian, Arizona.

The locality of this claim with reference to some natural object or permanent monument and additional information  
(if any) concerning its locality are as follows: 6,700 feet in a north easterly direction  
from Javelina dam.

DATED AND POSTED on the ground this 1st day of September, 2011.

LOCATOR (s) Bluefire Gem LLC

Agent - Vincent + Galindo

Form MCF100  
Revised July 2005

AMC 4-10432

**MINING CLAIM MAP**

Lode (X) Placer ( )

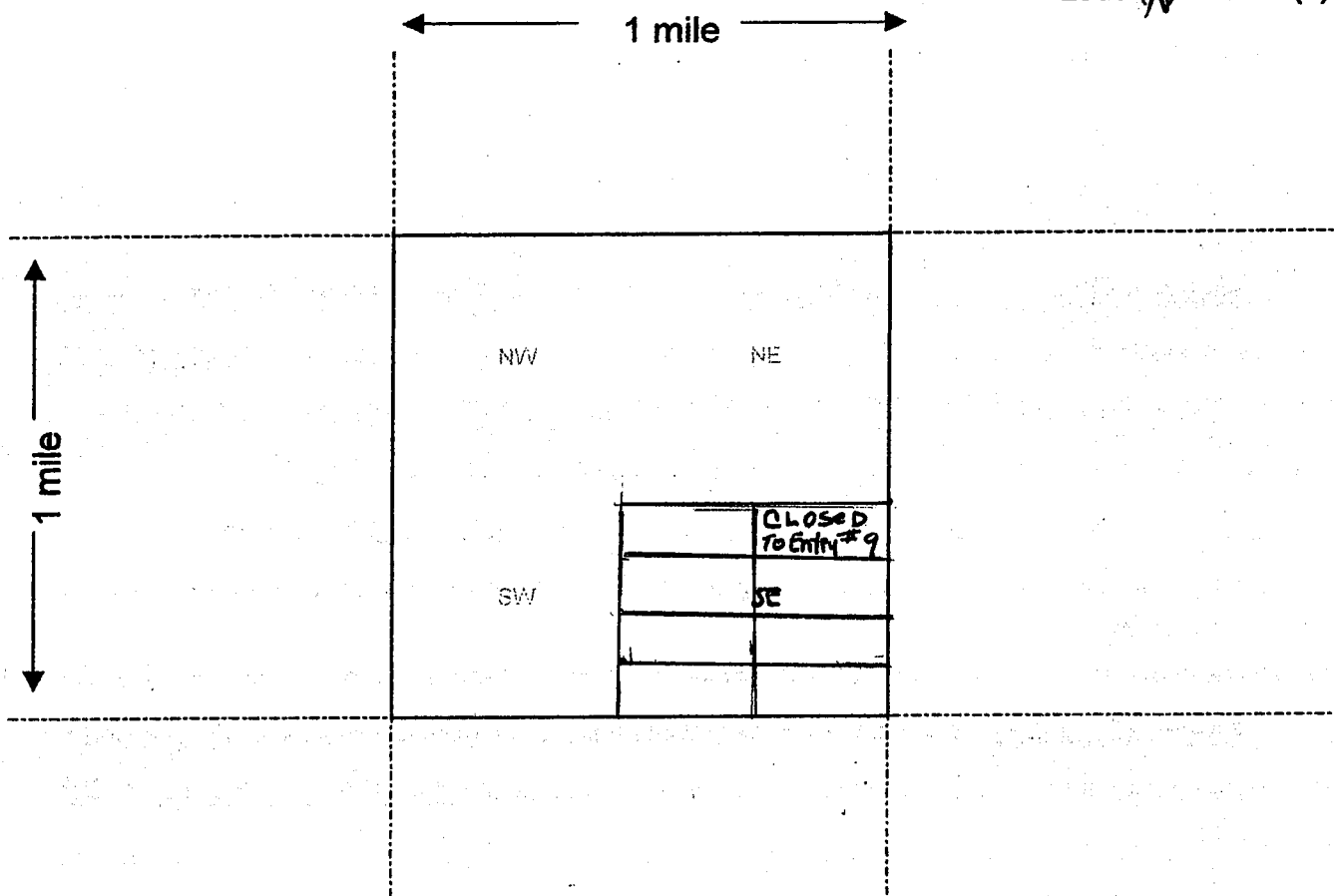

Scale : 1" = 2000 feet



1. The above map depicts the Closed to Entry #9 mining claim, which is located in Section (s) 25, Township 22 South, Range 11 EAST, Gila and Salt River Base and Meridian, SANTA CRUZ County, Arizona.

2. The type of corner and location monuments used are as follows: STONE AND POST

3. The bearings and distances in degrees and feet between claim corners are as depicted on the map.

Form MCF100a  
Revised July 2005

LOCATION NOTICE FOR LODE MINING CLAIM

NOTICE IS HEREBY GIVEN that the CLOSED TO ENTRY<sup>#</sup> 10  
\_\_\_\_\_ lode mining claim has been located  
by Bluefire Gem Co. LLC, whose current mailing  
address is P.O. Box 1916  
Tubac, AZ, 85646

RECEIVED  
BLM, AZ STATE OFFICE  
2011 SEP -6 A 11:13  
PHOENIX, AZ  
BLM  
Date  
Stamp

The general course of this claim is WEST TO EAST and it is situated in SANTA CRUZ  
County, Arizona. This claim is 1,500 feet in length and 600 feet in width. This claim runs  
from the location monument on which this location notice is posted approximately 750 feet in a  
due WEST direction to the WEST end line and 750 feet in a due EAST direction to the  
EAST end line. This claim is marked by six monuments, one at each corner and one at the center of each  
end line of the claim.

The location monument on which this notice is posted is situated within Section 25, Township 22 South  
11, Range 11 EAST, Gila Salt River Base and Meridian, Arizona and this claim encompasses portions  
of the following quarter section (s), section (s), Township (s) and Range (s) SE 1/4, SEC. 25, T. 22S,  
R 11 E and SW 1/4, SEC. 25, T. 22S, R 11 E.  
Gila Salt River Base and Meridian, Arizona.

The locality of this claim with reference to some natural object or permanent monument and additional information  
(if any) concerning its locality are as follows: 6,300 feet in a northerly direction  
from Javelina Dam

DATED AND POSTED on the ground this 1<sup>st</sup> day of September, 20 11.

LOCATOR (s) Bluefire Gem LLC

Agent - Vicent Galindo

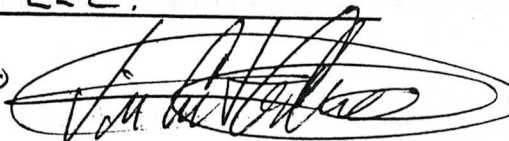

Form MCF100  
Revised July 2005

AMC 4 0433

**MINING CLAIM MAP**

Lode (X) Placer ( )

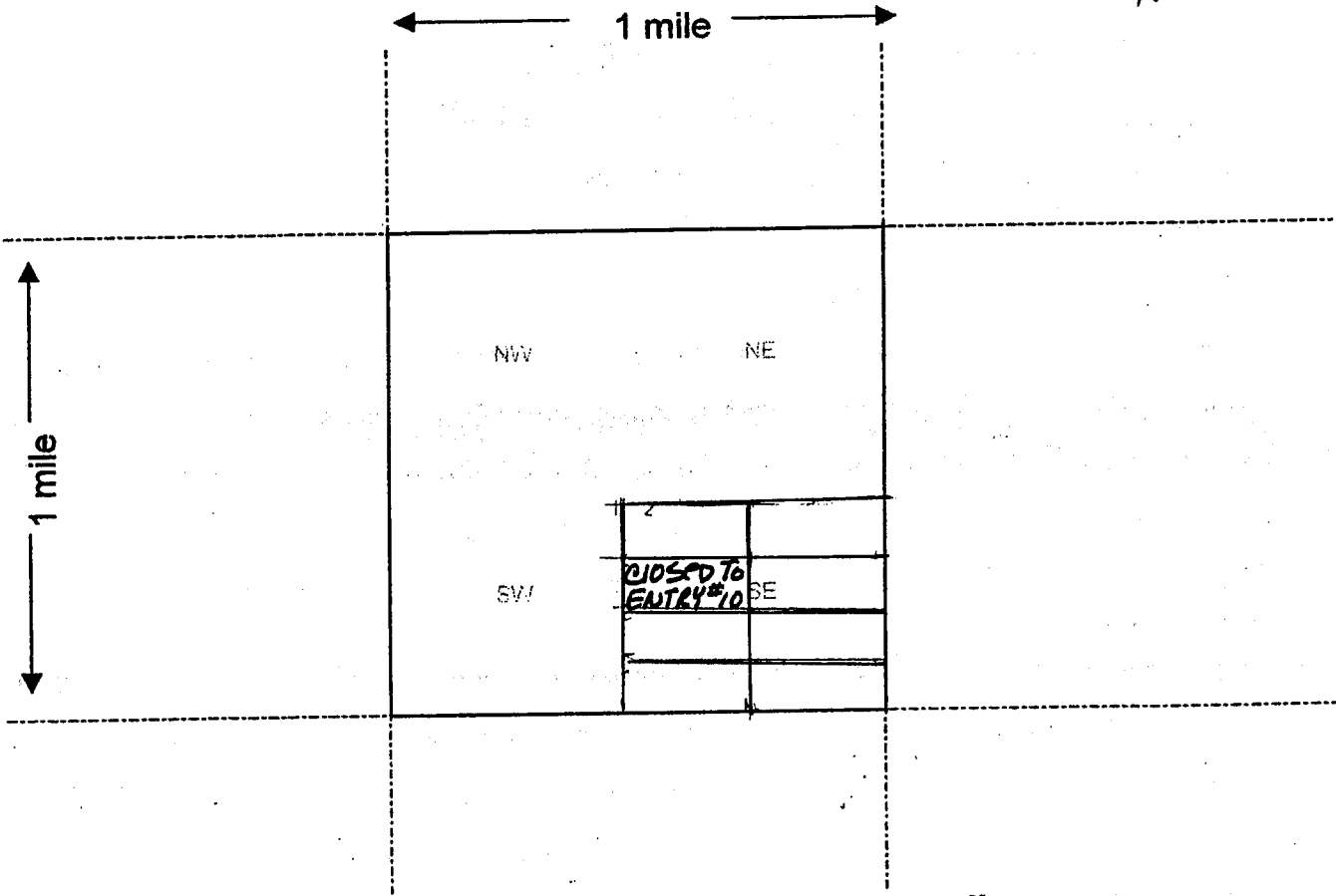

Scale : 1" = 2000 feet



1. The above map depicts the CLOSED TO ENTRY #10 mining claim, which is located in Section (s) 25, Township 22 SOUTH, Range 11 EAST, Gila and Salt River Base and Meridian, SANTA CRUZ County, Arizona.

2. The type of corner and location monuments used are as follows: STONE AND POST

3. The bearings and distances in degrees and feet between claim corners are as depicted on the map.

Form MCF100a  
Revised July 2005

LOCATION NOTICE FOR LODE MINING CLAIM

NOTICE IS HEREBY GIVEN that the CLOSED TO ENTRY #11  
\_\_\_\_\_ lode mining claim has been located  
by Bluefire Gem Co. LLC, whose current mailing  
address is P.O. Box 1916  
Tubac, Az. 85646

RECEIVED  
BLM, AZ STATE OFFICE  
2011 SEP - 6 A 11: 13  
PHOENIX, AZ  
BLM  
Date  
Stamp

The general course of this claim is West to East and it is situated in Santa Cruz  
County, Arizona. This claim is 4,500 feet in length and 600 feet in width. This claim runs  
from the location monument on which this location notice is posted approximately 750 feet in a  
due West direction to the WEST end line and 750 feet in a due east direction to the  
EAST end line. This claim is marked by six monuments, one at each corner and one at the center of each  
end line of the claim.

The location monument on which this notice is posted is situated within Section 25, Township 22 South  
\_\_\_\_\_, Range 11 East, Gila Salt River Base and Meridian, Arizona and this claim encompasses portions  
of the following quarter section (s), section (s), Township (s) and Range (s) SE 1/4, Sec 25,  
T 22 S, R 11 E  
Gila Salt River Base and Meridian, Arizona.

The locality of this claim with reference to some natural object or permanent monument and additional information  
(if any) concerning its locality are as follows: 6,650 feet in a north easterly  
direction from Javelina Dam

DATED AND POSTED on the ground this 1st day of September, 2011.

LOCATOR (s) Bluefire Gem Co, LLC

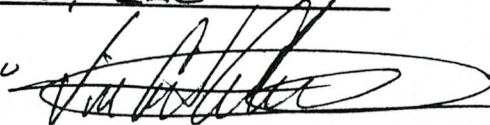
Agent - Vincent Galindo 

Form MCF100  
Revised July 2005

AMC410434

**MINING CLAIM MAP**

Lode (X) Placer ( )

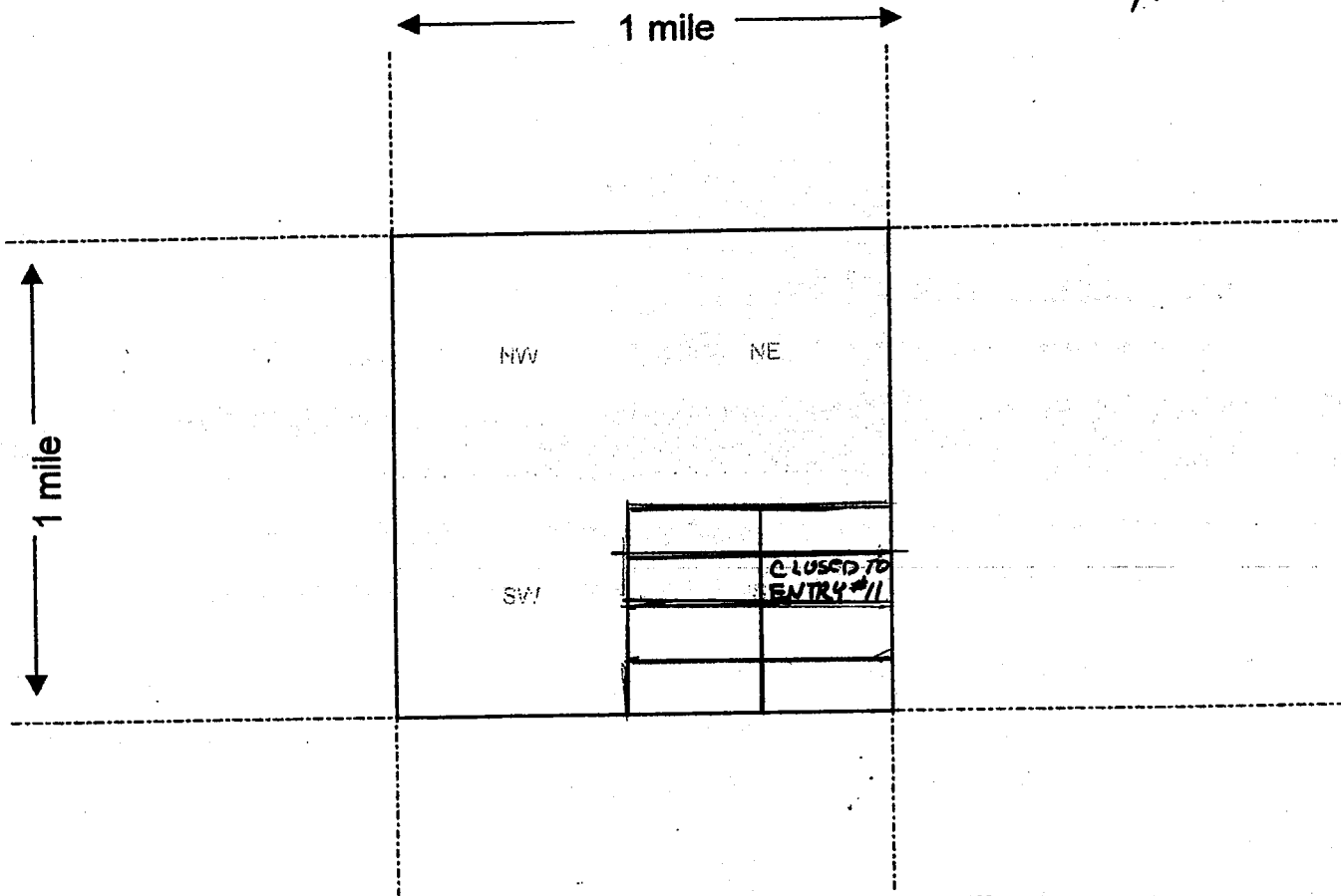

Scale : 1" = 2000 feet



1. The above map depicts the Closed to ENTRY #11 mining claim, which is located in Section (s) 25, Township 22 South, Range 11 EAST, Gila and Salt River Base and Meridian, Santa Cruz County, Arizona.

2. The type of corner and location monuments used are as follows: STONE AND POST

3. The bearings and distances in degrees and feet between claim corners are as depicted on the map.

Form MCF100a  
Revised July 2005

This form is available from the Arizona Department of Mines & Mineral Resources and may be reproduced.



LOCATION NOTICE FOR LODE MINING CLAIM

NOTICE IS HEREBY GIVEN that the CLOSED TO ENTRY #12  
\_\_\_\_\_ lode mining claim has been located  
by Bluefire Gem Co. LLC, whose current mailing  
address is P.O. Box 1914  
Tubac, Az. 85646

RECEIVED  
BLM, AZ STATE OFFICE  
2011 SEP -6 A 11:14  
PHOENIX, AZ  
BLM  
Date  
Stamp

The general course of this claim is WEST TO EAST and it is situated in Santa Cruz  
County, Arizona. This claim is 1,500 feet in length and 600 feet in width. This claim runs  
from the location monument on which this location notice is posted approximately 750 feet in a  
due west direction to the WEST end line and 750 feet in a due east direction to the  
east end line. This claim is marked by six monuments, one at each corner and one at the center of each  
end line of the claim.

The location monument on which this notice is posted is situated within Section 25, Township 22 South  
\_\_\_\_\_, Range 11 East, Gila Salt River Base and Meridian, Arizona and this claim encompasses portions  
of the following quarter section (s), section (s), Township (s) and Range (s) SE 1/4, Sec. 25,  
T 22 S, R 11 E AND SW 1/4, Sec. 25, T 22 S, R 11 E.  
Gila Salt River Base and Meridian, Arizona.

The locality of this claim with reference to some natural object or permanent monument and additional information  
(if any) concerning its locality are as follows: 3,800 feet in a northerly direction  
from Javelina Dam.

DATED AND POSTED on the ground this 15<sup>th</sup> day of September, 2011.

LOCATOR (s) Bluefire Gem LLC  
Agent - Vincent Gutino 

Form MCF100  
Revised July 2005

AN410435

**MINING CLAIM MAP**

Lode (X) Placer ( )

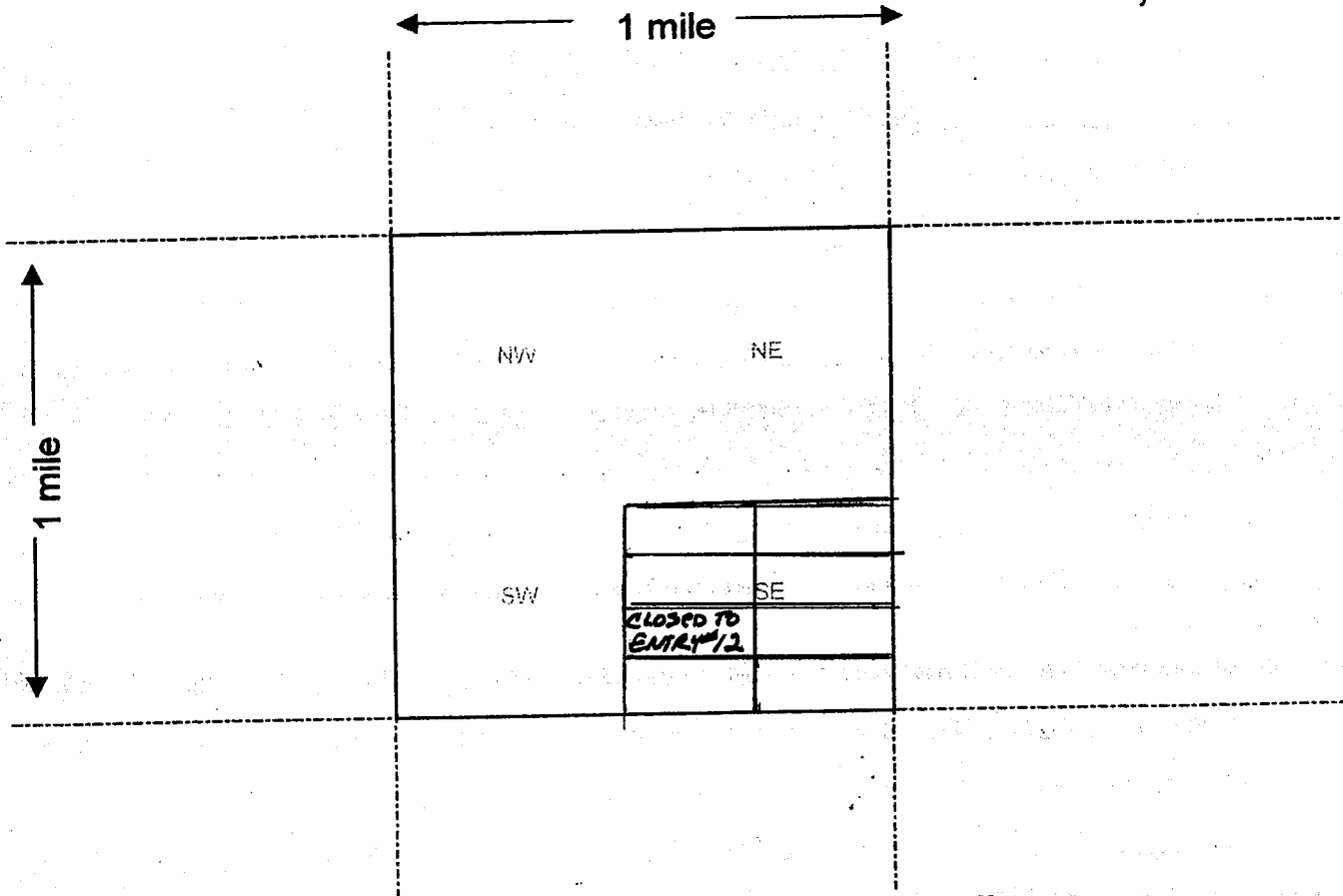

1. The above map depicts the CLOSED TO ENTRY #12 mining claim, which is located in Section (s) 25, Township 22 SOUTH, Range 11 EAST, Gila and Salt River Base and Meridian, \_\_\_\_\_ County, Arizona.

2. The type of corner and location monuments used are as follows: STONE AND POST

3. The bearings and distances in degrees and feet between claim corners are as depicted on the map.

Form MCF100a  
Revised July 2005

LOCATION NOTICE FOR LODE MINING CLAIM

NOTICE IS HEREBY GIVEN that the Closed to Entry #13

\_\_\_\_\_ lode mining claim has been located

by Bluefire Gem Co. LLC whose current mailing

address is P.O. Box 1916

Tubac, Az. 85646

RECEIVED BLM, AZ STATE OFFICE	2011 SEP - 6 A 11: 14	PHOENIX, AZ	BLM Date Stamp
----------------------------------	-----------------------	-------------	----------------------

The general course of this claim is West to EAST and it is situated in Santa Cruz County, Arizona. This claim is 1,500 feet in length and 600 feet in width. This claim runs from the location monument on which this location notice is posted approximately 750 feet in a due west direction to the west end line and 750 feet in a due east direction to the EAST end line. This claim is marked by six monuments, one at each corner and one at the center of each end line of the claim.

The location monument on which this notice is posted is situated within Section 25, Township 22 South, Range 11 EAST, Gila Salt River Base and Meridian, Arizona and this claim encompasses portions of the following quarter section (s), section (s), Township (s) and Range (s) SE 1/4, Sec. 25, T 22 S, R 11 E

Gila Salt River Base and Meridian, Arizona.

The locality of this claim with reference to some natural object or permanent monument and additional information (if any) concerning its locality are as follows: 6,200 feet in a north easterly direction from Javelina Dam.

DATED AND POSTED on the ground this 1st day of September, 20 11.

LOCATOR (s) Bluefire Gem Co. LLC

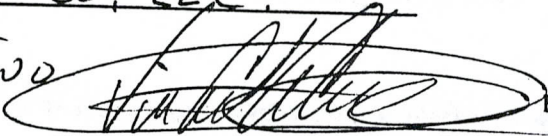
Agent - Vincent Cutilino  

Form MCF100  
Revised July 2005

AMC410436

**MINING CLAIM MAP**

Lode (X) Placer ( )

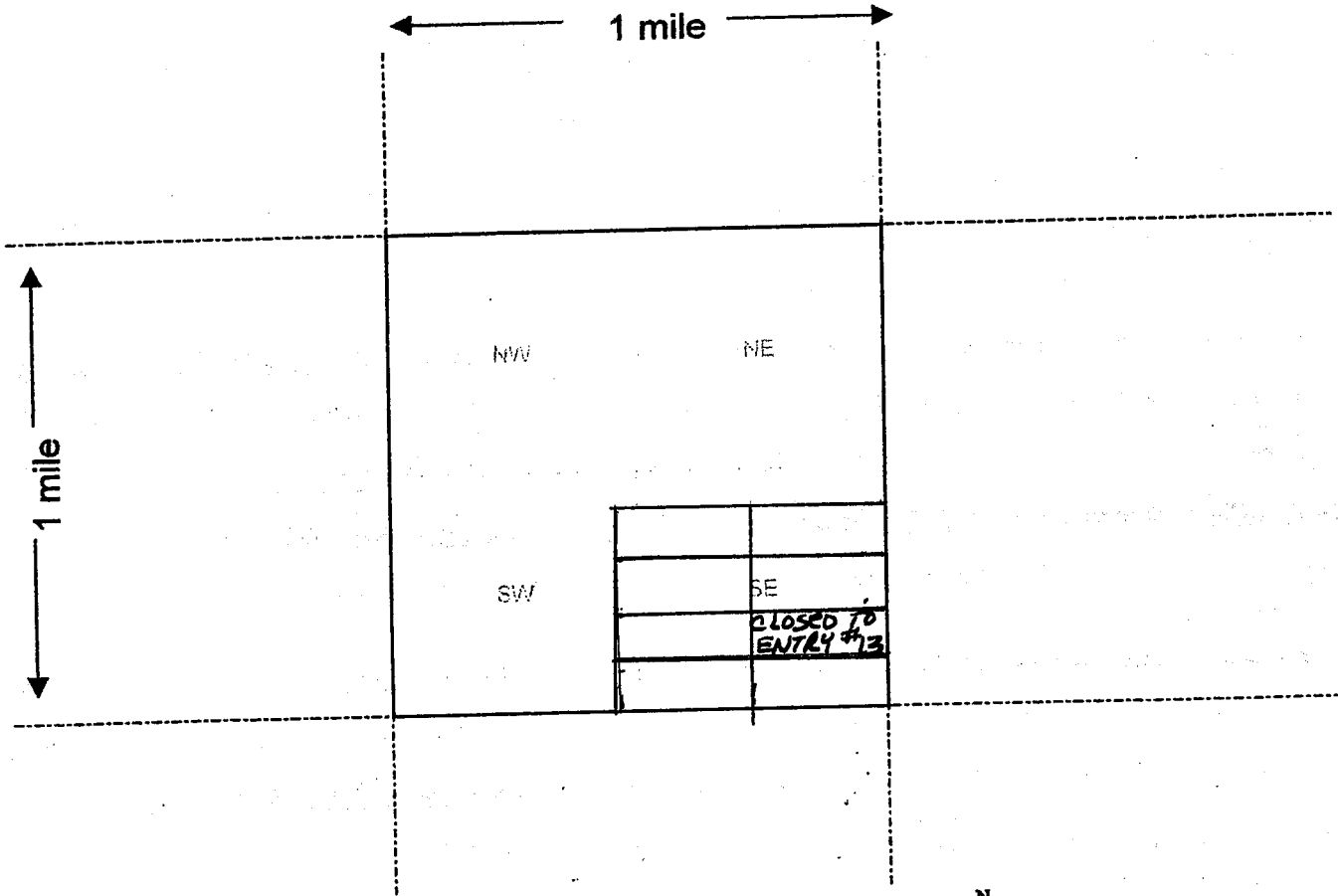

Scale: 1" = 2000 feet



1. The above map depicts the Closed to entry #13 mining claim, which is located in Section (s) 25, Township 22, Range 11, Gila and Salt River Base and Meridian, Santa Cruz County, Arizona.

2. The type of corner and location monuments used are as follows: STONE AND POST

3. The bearings and distances in degrees and feet between claim corners are as depicted on the map.

Form MCF100a  
Revised July 2005

This form is available from the Arizona Department of Mines & Mineral Resources and may be reproduced.

RECEIVED  
BLM  
AZ STATE OFFICE  
2011 SEP - 6 A 11: 14  
PHOENIX, AZ

LOCATION NOTICE FOR LODE MINING CLAIM

NOTICE IS HEREBY GIVEN that the CLOSED TO ENTRY #14

\_\_\_\_\_ lode mining claim has been located

by Bluefire Gem Co, LLC whose current mailing  
address is P.O. Box 1916  
Tubac, Az. 85646

BLM  
Date  
Stamp

The general course of this claim is West to East and it is situated in Santa Cruz  
County, Arizona. This claim is 1,500 feet in length and 600 feet in width. This claim runs  
from the location monument on which this location notice is posted approximately 750 feet in a  
due west direction to the west end line and 750 feet in a due east direction to the  
east end line. This claim is marked by six monuments, one at each corner and one at the center of each  
end line of the claim.

The location monument on which this notice is posted is situated within Section 25, Township 22 South  
\_\_\_\_\_, Range 11 East, Gila Salt River Base and Meridian, Arizona and this claim encompasses portions  
of the following quarter section (s), section (s), Township (s) and Range (s) SE 1/4, Sec. 25  
T 22 S, R 11 E And SW 1/4 Sec. 25, T 22 S R 11 E  
Gila Salt River Base and Meridian, Arizona.

The locality of this claim with reference to some natural object or permanent monument and additional information  
(if any) concerning its locality are as follows: 3,200 feet in a northerly direction  
from Javelina Dam

DATED AND POSTED on the ground this 1st day of September, 20 11.

LOCATOR (s) Bluefire Gem Co, LLC

Agent - Vincent Galindo 

Form MCF100  
Revised July 2005

AMC410437

**MINING CLAIM MAP**

Lode (X) Placer ( )

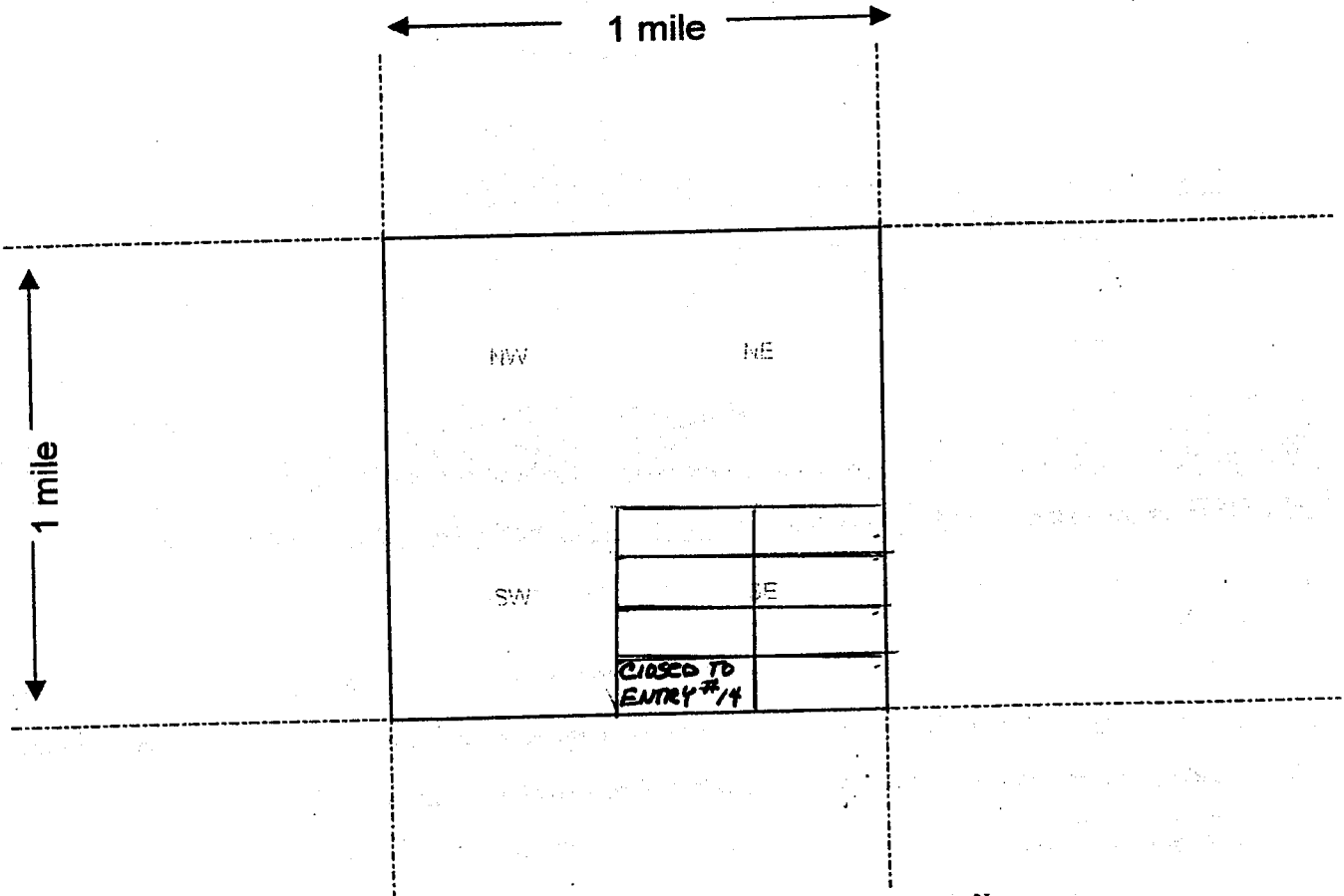

Scale : 1" = 2000 feet



1. The above map depicts the closed to entry # 14 mining claim, which is located in Section (s) 25, Township 22 South, Range 11 East, Gila and Salt River Base and Meridian, Santa Cruz County, Arizona.

2. The type of corner and location monuments used are as follows: stone and Post.

3. The bearings and distances in degrees and feet between claim corners are as depicted on the map.

Form MCF100a  
Revised July 2005

RECEIVED  
BLM, AZ STATE OFFICE

2011 SEP - 6 A 11: 14

PHOENIX, AZ

BLM  
Date  
Stamp

LOCATION NOTICE FOR LODE MINING CLAIM

NOTICE IS HEREBY GIVEN that the CLOSED TO ENTRY #15  
\_\_\_\_\_ lode mining claim has been located  
by Bluefire Gem Co. LLC, whose current mailing  
address is P.O. Box 1916  
Tubac, Az. 85646.

The general course of this claim is WEST TO EAST and it is situated in Santa Cruz  
County, Arizona. This claim is 4,500 feet in length and 600 feet in width. This claim runs  
from the location monument on which this location notice is posted approximately 750 feet in a  
due west direction to the west end line and 750 feet in a due east direction to the  
east end line. This claim is marked by six monuments, one at each corner and one at the center of each  
end line of the claim.

The location monument on which this notice is posted is situated within Section 25, Township 22 South  
\_\_\_\_\_, Range 11 EAST, Gila Salt River Base and Meridian, Arizona and this claim encompasses portions  
of the following quarter section (s), section (s), Township (s) and Range (s) SE 1/4, Sec. 25,  
T 22 S, R 11 E

Gila Salt River Base and Meridian, Arizona.

The locality of this claim with reference to some natural object or permanent monument and additional information  
(if any) concerning its locality are as follows: 5,600 feet in a north easterly  
direction from JAUELINA DAM

DATED AND POSTED on the ground this 15<sup>th</sup> day of September, 20 11.

LOCATOR (s) Bluefire Gem Co. LLC

Agent - Vincent Calvo

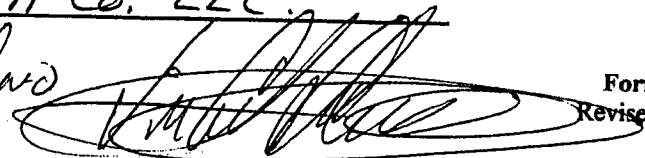

Form MCF100  
Revised July 2005

AMC410438

**MINING CLAIM MAP**

Lode (X) Placer ( )

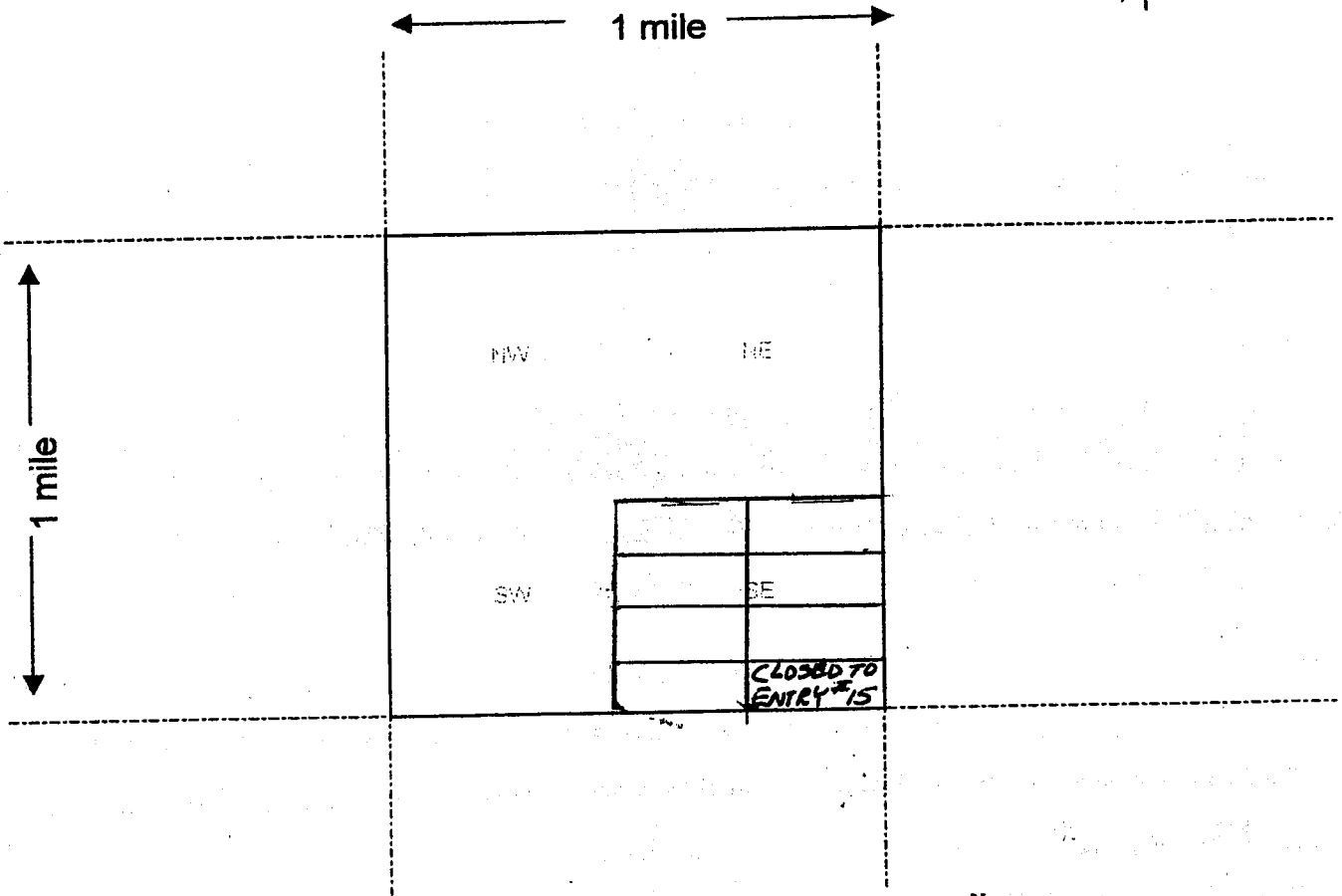

Scale : 1" = 2000 feet



1. The above map depicts the CLOSED TO ENTRY #15 mining claim, which is located in Section (s) 25, Township 22, Range 11 EAST, Gila and Salt River Base and Meridian, SANTA CRUZ County, Arizona.

2. The type of corner and location monuments used are as follows: STONE AND POST.

3. The bearings and distances in degrees and feet between claim corners are as depicted on the map.

Form MCF100a  
Revised July 2005

This form is available from the Arizona Department of Mines & Mineral Resources and may be reproduced.



RECEIVED  
BLM  
AZ STATE OFFICE

2011  
SEP - 6 A 11: 14

PHOENIX, AZ

BLM Date Stamp
----------------------

**LOCATION NOTICE FOR LODE MINING CLAIM**

NOTICE IS HEREBY GIVEN that the RESTRICTED AREA #1

\_\_\_\_\_ lode mining claim has been located  
by Forest Mining Co. LLC whose current mailing  
address is P.O. Box 1916  
Tubac, Az. 85646.

The general course of this claim is north to south and it is situated in Santa Cruz  
County, Arizona. This claim is 1,500 feet in length and 600 feet in width. This claim runs  
from the location monument on which this location notice is posted approximately 750 feet in a  
NNW direction to the NORTH end line and 750 feet in a SSE direction to the  
SOUTH end line. This claim is marked by six monuments, one at each corner and one at the center of each  
end line of the claim.

The location monument on which this notice is posted is situated within Section 27, Township 22 SOUTH  
\_\_\_\_\_, Range 11 EAST, Gila Salt River Base and Meridian, Arizona and this claim encompasses portions  
of the following quarter section (s), section (s), Township (s) and Range (s) SE 1/4, sec. 27,  
T 22 S, R 11 E.

Gila Salt River Base and Meridian, Arizona.

The locality of this claim with reference to some natural object or permanent monument and additional information  
(if any) concerning its locality are as follows: 2 miles west of Ruby Peak

DATED AND POSTED on the ground this 1st day of September, 20 11.

LOCATOR (s) Forest Mining Co. LLC

Agent - Vincent Galindo

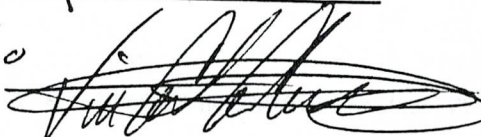

Form MCF100  
Revised July 2005

AMC410439

**MINING CLAIM MAP**

Lode  Placer ( )

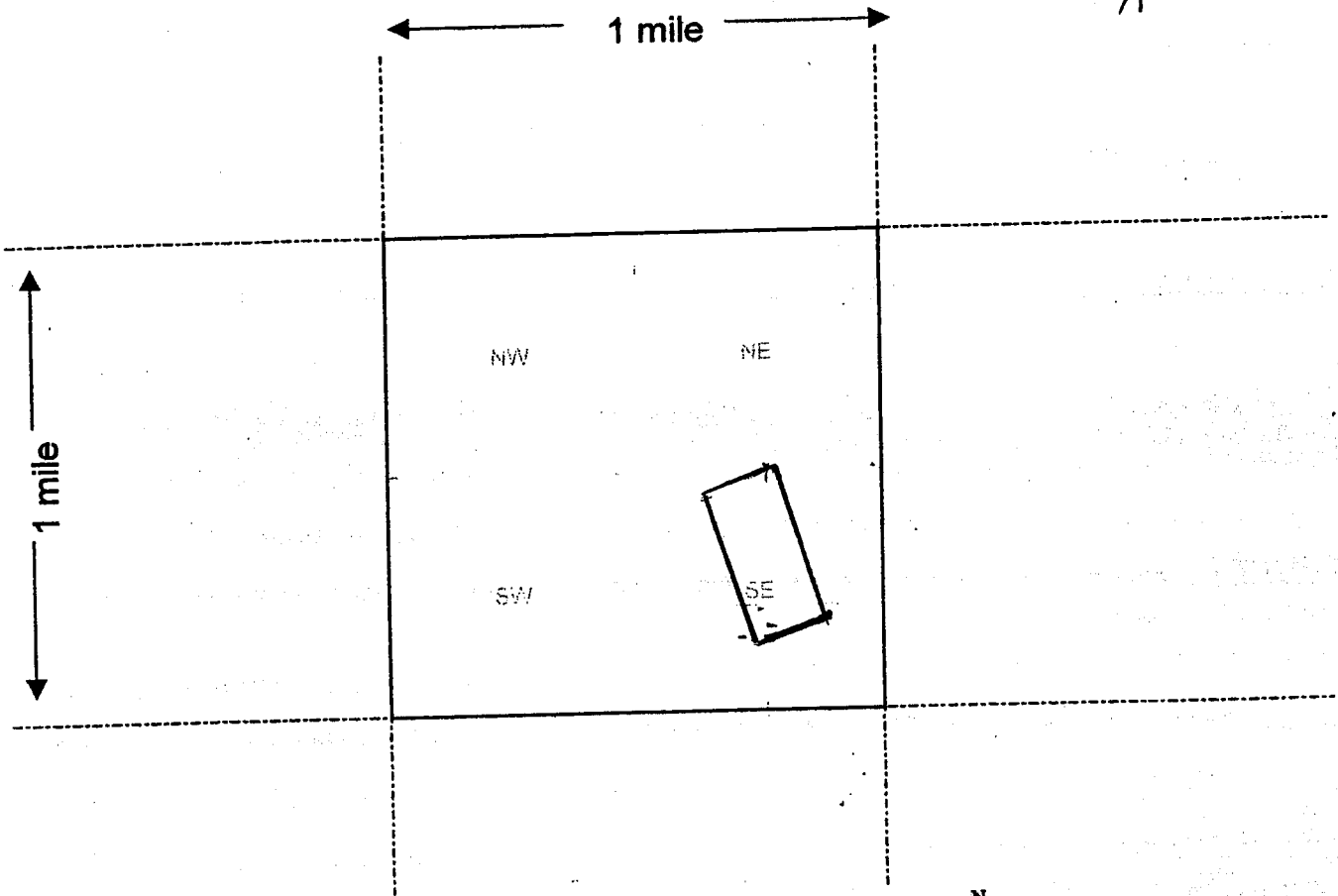

Scale : 1" = 2000 feet



1. The above map depicts the RESTRICTED AREA #1 mining claim, which is located in Section (s) 27, Township 22 SOUTH, Range 11 EAST, Gila and Salt River Base and Meridian, SANTA CRUZ County, Arizona.

2. The type of corner and location monuments used are as follows: POST + STONE

3. The bearings and distances in degrees and feet between claim corners are as depicted on the map.

Form MCF100a  
Revised July 2005

LOCATION NOTICE FOR LODE MINING CLAIM

NOTICE IS HEREBY GIVEN that the RESTRICTED AREA #2  
\_\_\_\_\_ lode mining claim has been located  
by Forest Mining Co. LLC whose current mailing  
address is P.O. Box 1916  
Tubac, Az. 85646

RECEIVED  
BLM, AZ STATE OFFICE  
2011 SEP -6 A 11: 14  
PHOENIX, AZ  
BLM  
Date  
Stamp

The general course of this claim is north to south and it is situated in Santa Cruz  
County, Arizona. This claim is 1,500 feet in length and 600 feet in width. This claim runs  
from the location monument on which this location notice is posted approximately 750 feet in a  
NNW direction to the NORTH end line and 750 feet in a SSE direction to the  
SOUTH end line. This claim is marked by six monuments, one at each corner and one at the center of each  
end line of the claim.

The location monument on which this notice is posted is situated within Section 27, Township 22 south  
\_\_\_\_\_, Range 11 EAST, Gila Salt River Base and Meridian, Arizona and this claim encompasses portions  
of the following quarter section (s), section (s), Township (s) and Range (s) SE 1/4, sec. 27,  
T 22 S, R 11 E

Gila Salt River Base and Meridian, Arizona.

The locality of this claim with reference to some natural object or permanent monument and additional information  
(if any) concerning its locality are as follows: 2 miles west of Ruby Peak.

DATED AND POSTED on the ground this 15<sup>th</sup> day of September, 20 11.

LOCATOR (s) Forest Mining Co. LLC.

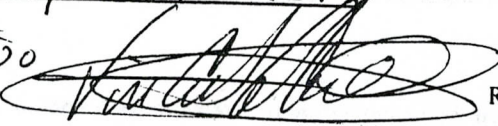
Agent - Vincent Buliwo  

Form MCF100  
Revised July 2005

AMC410440

**MINING CLAIM MAP**

Lode  Placer ( )

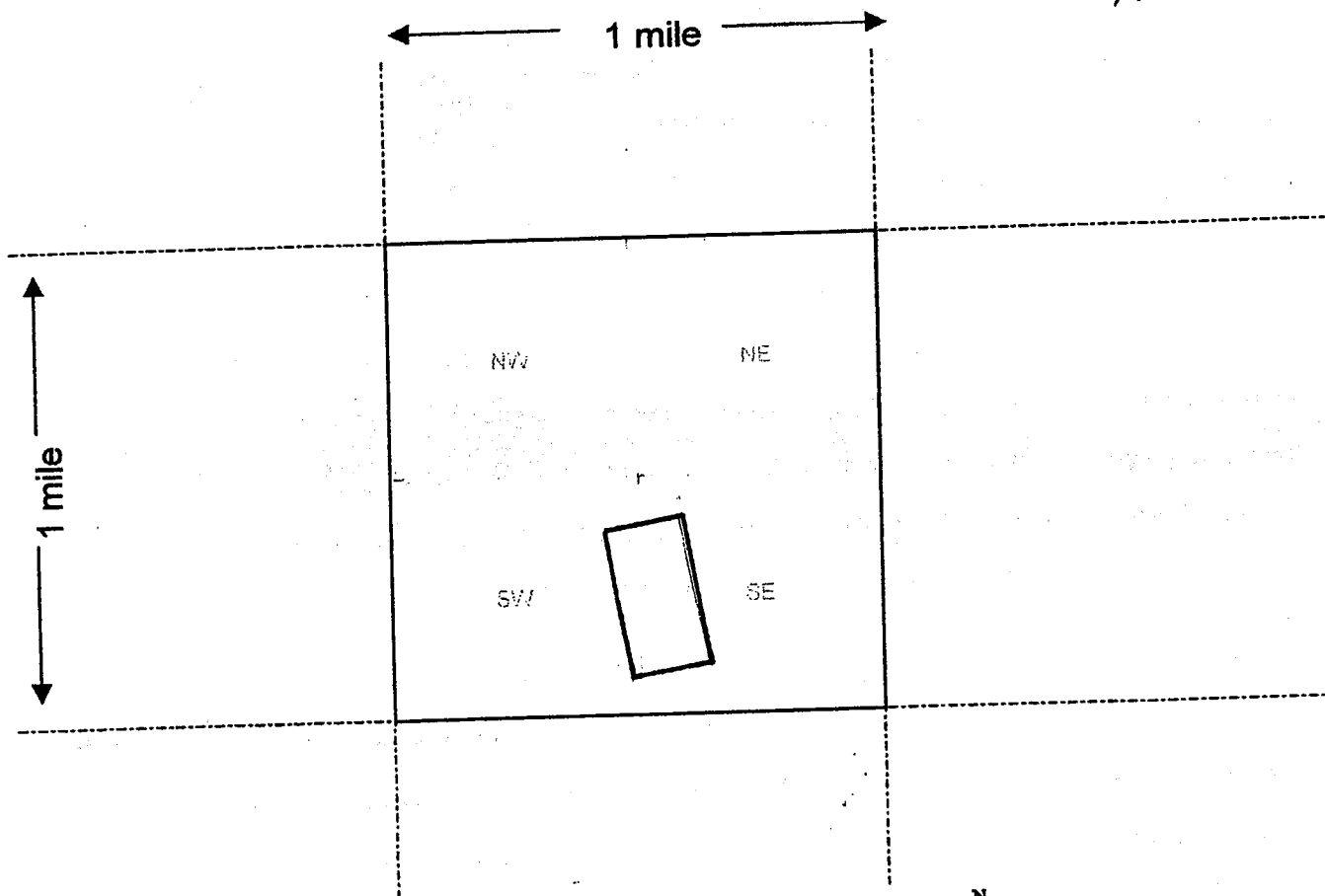

Scale : 1" = 2000 feet



1. The above map depicts the RESTRICTED AREA # 2 mining claim, which is located in Section (s) 27, Township 22 S, Range 11 E, Gila and Salt River Base and Meridian,

Santa Cruz County, Arizona.

2. The type of corner and location monuments used are as follows: post and stone

3. The bearings and distances in degrees and feet between claim corners are as depicted on the map.

Form MCF100a  
Revised July 2005

LOCATION NOTICE FOR LODE MINING CLAIM

NOTICE IS HEREBY GIVEN that the RESTRICTED AREA #3

lode mining claim has been located

by Forest Mining Co. LLC whose current mailing

address is P.O. Box 1916

Tubac, Az. 85646

BLM  
Date  
Stamp

PHOENIX, AZ

2011 SEP - 6 A 11: 14

RECEIVED  
B.L.M. AZ STATE OFFICE

The general course of this claim is north to south and it is situated in Santa Cruz

County, Arizona. This claim is 4,500 feet in length and 600 feet in width. This claim runs

from the location monument on which this location notice is posted approximately 750 feet in a

NNW direction to the NORTH end line and 750 feet in a SSE direction to the

SOUTH end line. This claim is marked by six monuments, one at each corner and one at the center of each end line of the claim.

The location monument on which this notice is posted is situated within Section 27, Township 22 South.

Range 11 EAST, Gila Salt River Base and Meridian, Arizona and this claim encompasses portions

of the following quarter section (s), section (s), Township (s) and Range (s) SW 1/4, SEC 27,

T 22 S, R 11 E.

Gila Salt River Base and Meridian, Arizona.

The locality of this claim with reference to some natural object or permanent monument and additional information

(if any) concerning its locality are as follows: 2 miles east of Ruby Peak.

DATED AND POSTED on the ground this 1st day of September, 20 11.

LOCATOR (s) Forest Mining Co. LLC,

Agent - Vincent Galindo

Form MCF100  
Revised July 2005

AMC410441

**MINING CLAIM MAP**

Lode  Placer ( )

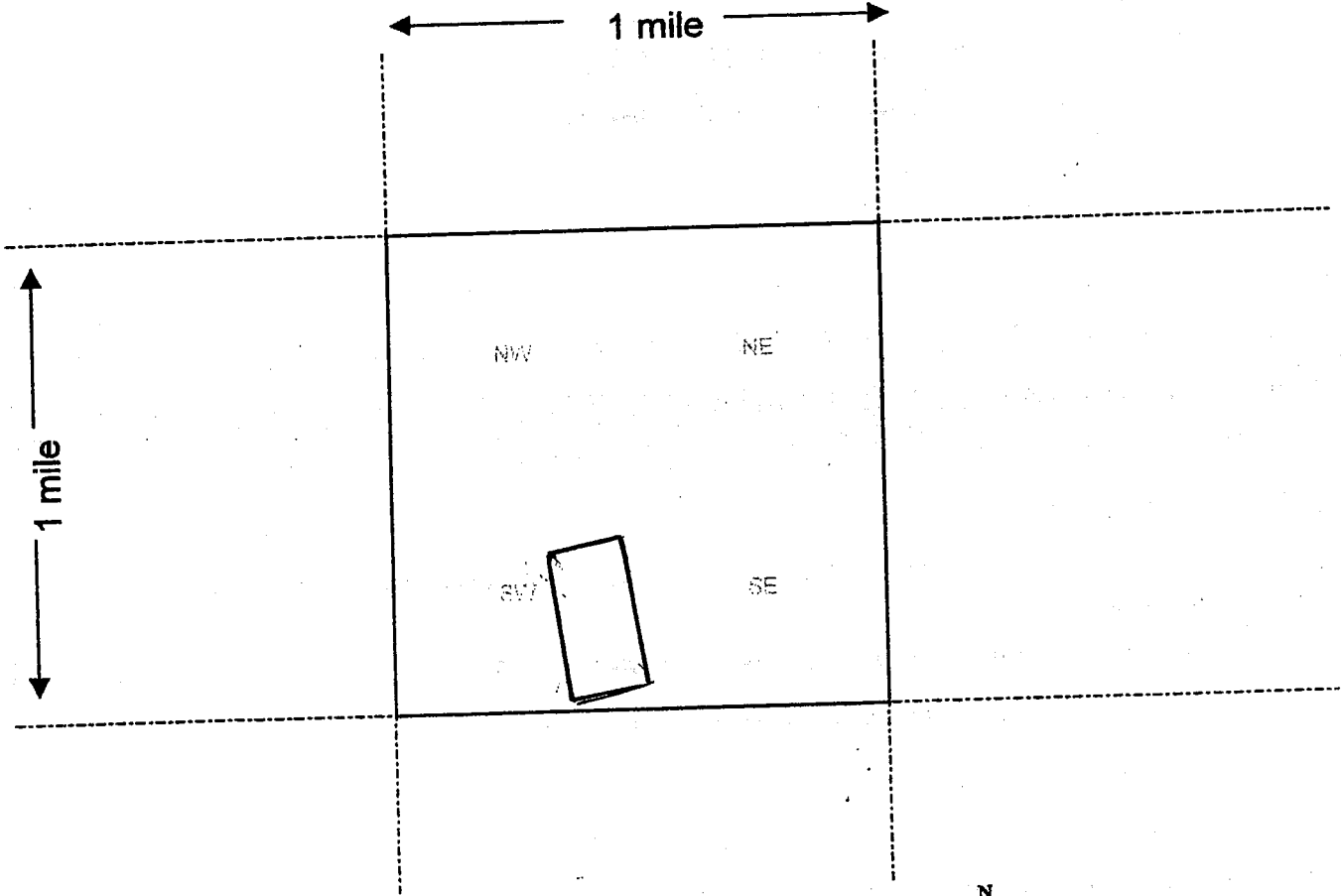

Scale : 1" = 2000 feet



1. The above map depicts the RESTRICTED AREA #3 mining claim, which is located in Section (s) 27, Township 22 S, Range 11 E, Gila and Salt River Base and Meridian,

SANTA CRUZ County, Arizona.

2. The type of corner and location monuments used are as follows: post AND stone

3. The bearings and distances in degrees and feet between claim corners are as depicted on the map.

Form MCF100a  
Revised July 2005

LOCATION NOTICE FOR LODE MINING CLAIM

NOTICE IS HEREBY GIVEN that the RESTRICTED AREA #4  
\_\_\_\_\_ lode mining claim has been located  
by Forest Mining Co. LLC, whose current mailing  
address is P.O. Box 1916  
Tubac, Az. 85646

RECEIVED  
B.L.M. AZ STATE OFFICE  
2011 SEP - 6 A 11: 14  
PHOENIX, AZ  
BLM  
Date  
Stamp

The general course of this claim is North to south and it is situated in Santa Cruz  
County, Arizona. This claim is 1,500 feet in length and 600 feet in width. This claim runs  
from the location monument on which this location notice is posted approximately 750 feet in a  
NNW direction to the NORTH end line and 750 feet in a SSE direction to the  
SOUTH end line. This claim is marked by six monuments, one at each corner and one at the center of each  
end line of the claim.

The location monument on which this notice is posted is situated within Section 27, Township 22 south  
\_\_\_\_\_, Range 11 EAST, Gila Salt River Base and Meridian, Arizona and this claim encompasses portions  
of the following quarter section (s), section (s), Township (s) and Range (s) SW 1/4, and NW 1/4,  
Sec 27, T22S, R11E.

Gila Salt River Base and Meridian, Arizona.

The locality of this claim with reference to some natural object or permanent monument and additional information  
(if any) concerning its locality are as follows: 2 miles east of Ruby Peak

DATED AND POSTED on the ground this 27<sup>th</sup> day of September, 20 11.

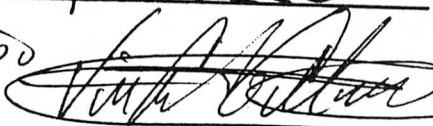
LOCATOR (s) Forest Mining Co. LLC  
Agent - Vincent Galindo 

Form MCF100  
Revised July 2005

AMC410442

**MINING CLAIM MAP**

Lode (X) Placer ( )

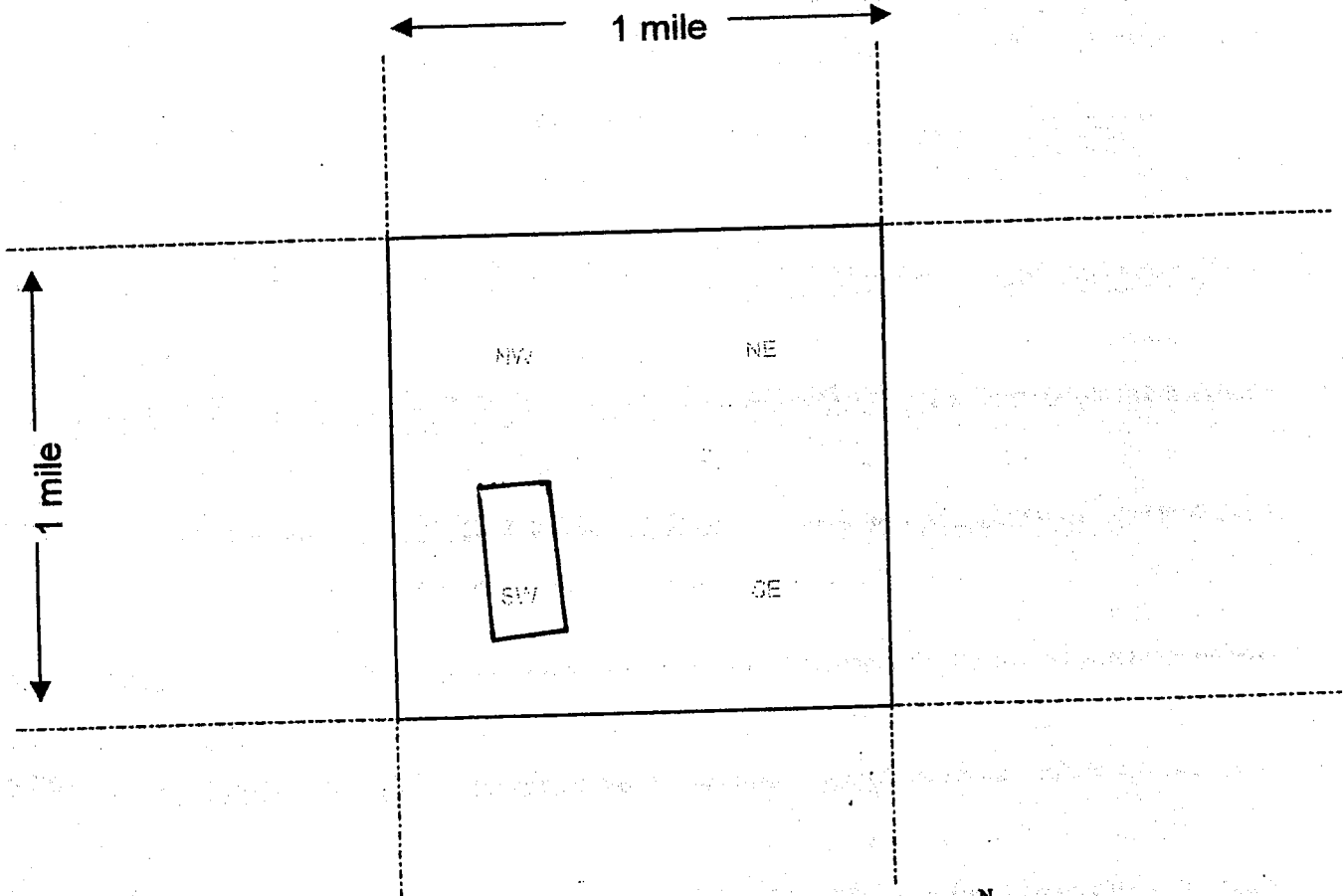

Scale : 1" = 2000 feet

1. The above map depicts the RESTRICTED AREA #4 mining claim, which is located in Section (s) 27, Township 22 S, Range 11 E, Gila and Salt River Base and Meridian,

SANTA CRUZ County, Arizona.

2. The type of corner and location monuments used are as follows: post And stone

3. The bearings and distances in degrees and feet between claim corners are as depicted on the map.

Form MCF100a  
Revised July 2005

This form is available from the Arizona Department of Mines & Mineral Resources and may be reproduced.



LOCATION NOTICE FOR LODE MINING CLAIM

NOTICE IS HEREBY GIVEN that the RESTRICTED AREA # 5

\_\_\_\_\_ lode mining claim has been located  
by Forest Mining Co. LLC whose current mailing  
address is P.O. Box 1916  
Tubac, Az. 85646

RECEIVED  
BLM, AZ STATE OFFICE  
2011 SEP -6 A 11: 14  
PHOENIX, AZ  
BLM  
Date  
Stamp

The general course of this claim is EAST TO WEST and it is situated in SANTA CRUZ  
County, Arizona. This claim is 1,500 feet in length and 600 feet in width. This claim runs  
from the location monument on which this location notice is posted approximately 750 feet in a  
EASTERLY direction to the EAST end line and 750 feet in a WESTERLY direction to the  
WEST end line. This claim is marked by six monuments, one at each corner and one at the center of each  
end line of the claim.

The location monument on which this notice is posted is situated within Section 27, Township 22 SOUTH  
\_\_\_\_\_, Range 11 EAST, Gila Salt River Base and Meridian, Arizona and this claim encompasses portions  
of the following quarter section (s), section (s), Township (s) and Range (s) NW 1/4 And NE 1/4,  
SEC. 27, T 22 S, R 11 E.

Gila Salt River Base and Meridian, Arizona.

The locality of this claim with reference to some natural object or permanent monument and additional information  
(if any) concerning its locality are as follows: 2 miles EAST OF Ruby Peak

DATED AND POSTED on the ground this 1st day of September, 20 11.

LOCATOR (s) Forest Mining Co. LLC.

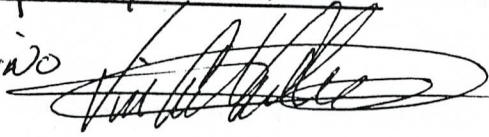
Agent - VINCENT GULINO 

Form MCF100  
Revised July 2005

AMC410443

**MINING CLAIM MAP**

Lode  Placer ( )

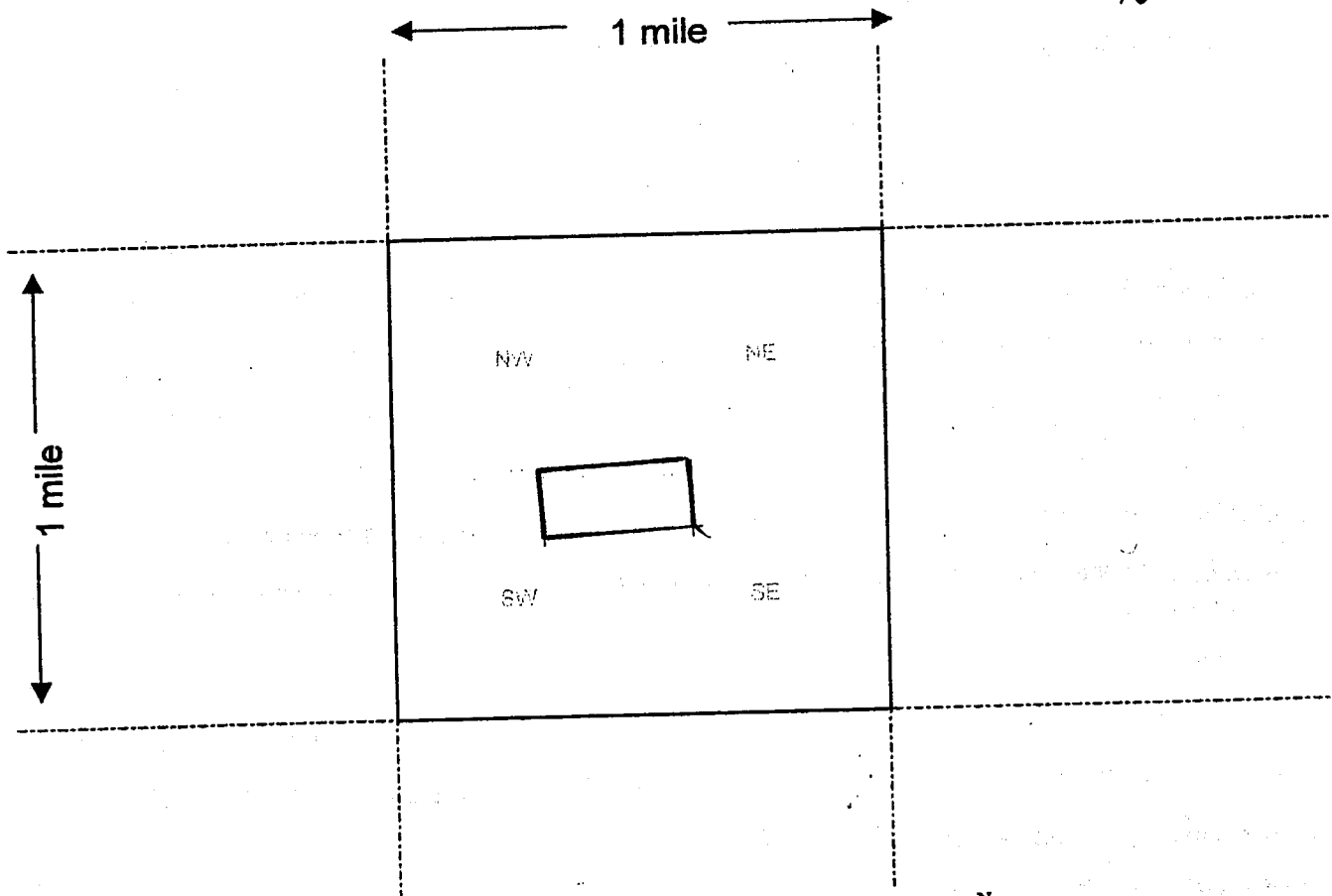

Scale : 1" = 2000 feet



1. The above map depicts the RESTRICTED AREA #5 mining claim, which is located in Section (s) 27, Township 22 S, Range 11 E, Gila and Salt River Base and Meridian,

SANTA CRUZ County, Arizona.

2. The type of corner and location monuments used are as follows: post and stone

3. The bearings and distances in degrees and feet between claim corners are as depicted on the map.

Form MCF100a  
Revised July 2005

This form is available from the Arizona Department of Mines & Mineral Resources and may be reproduced.

LOCATION NOTICE FOR LODE MINING CLAIM

NOTICE IS HEREBY GIVEN that the Van Nostrand -  
McCafferty Mine #1 lode mining claim has been located  
by Bluefire Gold Co, LLC whose current mailing  
address is P.O. Box 1916  
Tubac, AZ. 85646

RECEIVED  
BLM, AZ STATE OFFICE  
2011 SEP -6 A 11: 14  
PHOENIX, AZ  
BLM  
Date  
Stamp

The general course of this claim is NORTH TO SOUTH and it is situated in Pima  
County, Arizona. This claim is 1,500 feet in length and 600 feet in width. This claim runs  
from the location monument on which this location notice is posted approximately 750 feet in a  
southerly direction to the south end line and 750 feet in a northerly direction to the  
NORTH end line. This claim is marked by six monuments, one at each corner and one at the center of each  
end line of the claim.

The location monument on which this notice is posted is situated within Section 18, Township 21 SOUTH  
Range 10 EAST Gila Salt River Base and Meridian, Arizona and this claim encompasses portions  
of the following quarter section (s), section (s), Township (s) and Range (s) NW 1/4, Sec 18,  
T 21 S, R 10 E,

Gila Salt River Base and Meridian, Arizona.

The locality of this claim with reference to some natural object or permanent monument and additional information  
(if any) concerning its locality are as follows: 1/2 mile NNW of BM 3566

DATED AND POSTED on the ground this 1st day of September 20 11.

LOCATOR (s) Bluefire Gold Co, LLC.

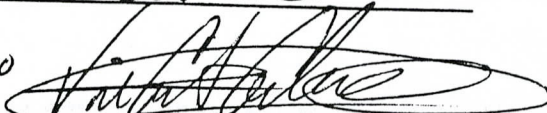
Agent - Vincent Galindo 

Form MCF100  
Revised July 2005

AMC410444

**MINING CLAIM MAP**

Lode (X) Placer ( )

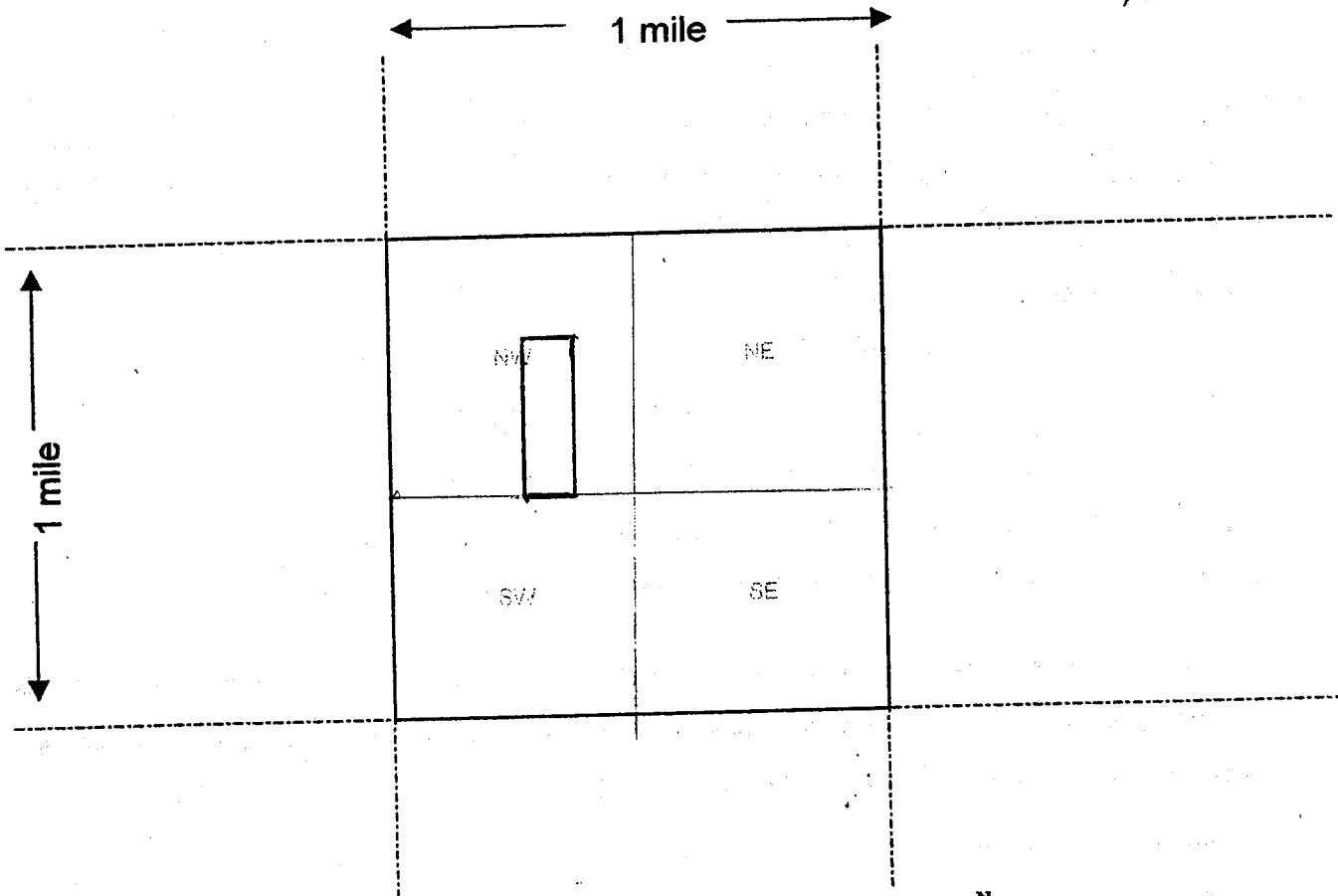

Scale : 1" = 2000 feet



1. The above map depicts the Van Nostrand-McCaferly Mine mining claim, which is located in Section (s) 18, Township 21 South, Range 10 East, Gila and Salt River Base and Meridian, Pima County, Arizona.

2. The type of corner and location monuments used are as follows: STONE AND POST

3. The bearings and distances in degrees and feet between claim corners are as depicted on the map.

Form MCF100a  
Revised July 2005

This form is available from the Arizona Department of Mines & Mineral Resources and may be reproduced.

RECEIVED  
B.L.M. AZ STATE OFFICE

2011 SEP - 6 A 11: 15

PHOENIX, AZ

BLM  
Date  
Stamp

LOCATION NOTICE FOR LODE MINING CLAIM

NOTICE IS HEREBY GIVEN that the Van Nostrand-McAfferly  
Mine #2 lode mining claim has been located  
by Bluefire Gold Co. LLC whose current mailing  
address is P.O. Box 1916  
Tubac, Az. 85646

The general course of this claim is north to south and it is situated in Pima  
County, Arizona. This claim is 1,500 feet in length and 600 feet in width. This claim runs  
from the location monument on which this location notice is posted approximately 750 feet in a  
southerly direction to the south end line and 750 feet in a northerly direction to the  
NORTH end line. This claim is marked by six monuments, one at each corner and one at the center of each  
end line of the claim.

The location monument on which this notice is posted is situated within Section 18, Township 21 SOUTH  
Range 10 EAST, Gila Salt River Base and Meridian, Arizona and this claim encompasses portions  
of the following quarter section (s), section (s), Township (s) and Range (s) NW 1/4, Sec. 18,  
T 21 S, R 10 E.

Gila Salt River Base and Meridian, Arizona.

The locality of this claim with reference to some natural object or permanent monument and additional information  
(if any) concerning its locality are as follows: 1/2 mile NNW of BM 3566

DATED AND POSTED on the ground this 1st day of September, 20 11.

LOCATOR (s) Bluefire Gold Co. LLC.

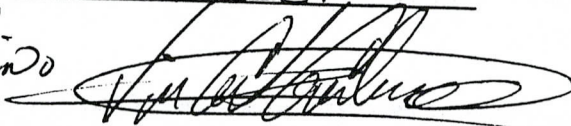
Agent - Vincent Galindo 

Form MCF100  
Revised July 2005

AMC410445

MINING CLAIM MAP

Lode (X) Placer ( )

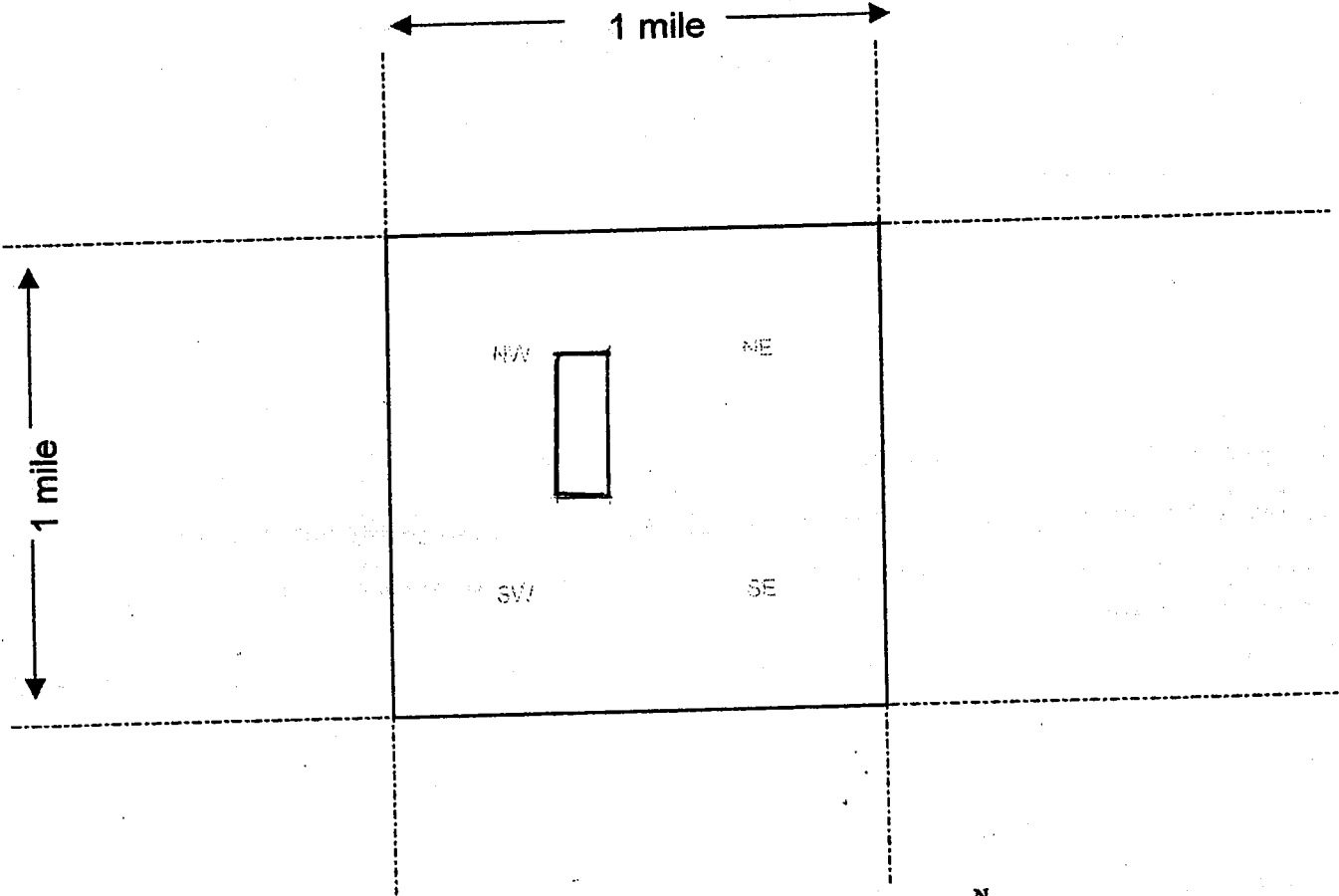

Scale : 1" = 2000 feet

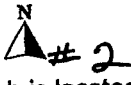

1. The above map depicts the Van Nostrand-McCarthy Mine #2 mining claim, which is located in Section (s) 18, Township 21 SOUTH, Range 10 EAST, Gila and Salt River Base and Meridian, Pima County, Arizona.
2. The type of corner and location monuments used are as follows: stone and Post
3. The bearings and distances in degrees and feet between claim corners are as depicted on the map.

Form MCF100a  
Revised July 2005

This form is available from the Arizona Department of Mines & Mineral Resources and may be reproduced.

LOCATION NOTICE FOR LODE MINING CLAIM

NOTICE IS HEREBY GIVEN that the VAN Nostrand -  
McCafferty Mine #3 lode mining claim has been located  
by Bluefire Gold Co. LLC, whose current mailing  
address is P.O. Box 19116  
Tubac, Az. 85646

RECEIVED  
BLM, AZ STATE OFFICE  
2011 SEP -6 A 11:15  
PHOENIX, AZ  
BLM  
Date  
Stamp

The general course of this claim is north to south and it is situated in Pima  
County, Arizona. This claim is 1,500 feet in length and 600 feet in width. This claim runs  
from the location monument on which this location notice is posted approximately 750 feet in a  
southerly direction to the south end line and 750 feet in a northerly direction to the  
NORTH end line. This claim is marked by six monuments, one at each corner and one at the center of each  
end line of the claim.

The location monument on which this notice is posted is situated within Section 18, Township 21 south  
Range 10 EAST, Gila Salt River Base and Meridian, Arizona and this claim encompasses portions  
of the following quarter section (s), section (s), Township (s) and Range (s) NW 1/4, sec 18, and  
SW 1/4, sec. 7, T 21 S, R 10 E.

Gila Salt River Base and Meridian, Arizona.

The locality of this claim with reference to some natural object or permanent monument and additional information  
(if any) concerning its locality are as follows: 3/4 mile NNW of BM 3566

DATED AND POSTED on the ground this 1st day of September, 20 11.

LOCATOR (s) Bluefire Gold Co. LLC.

Agent - VINCENT Galindo  

Form MCF100  
Revised July 2005

AMC410446

**MINING CLAIM MAP**

Lode (X) Placer ( )

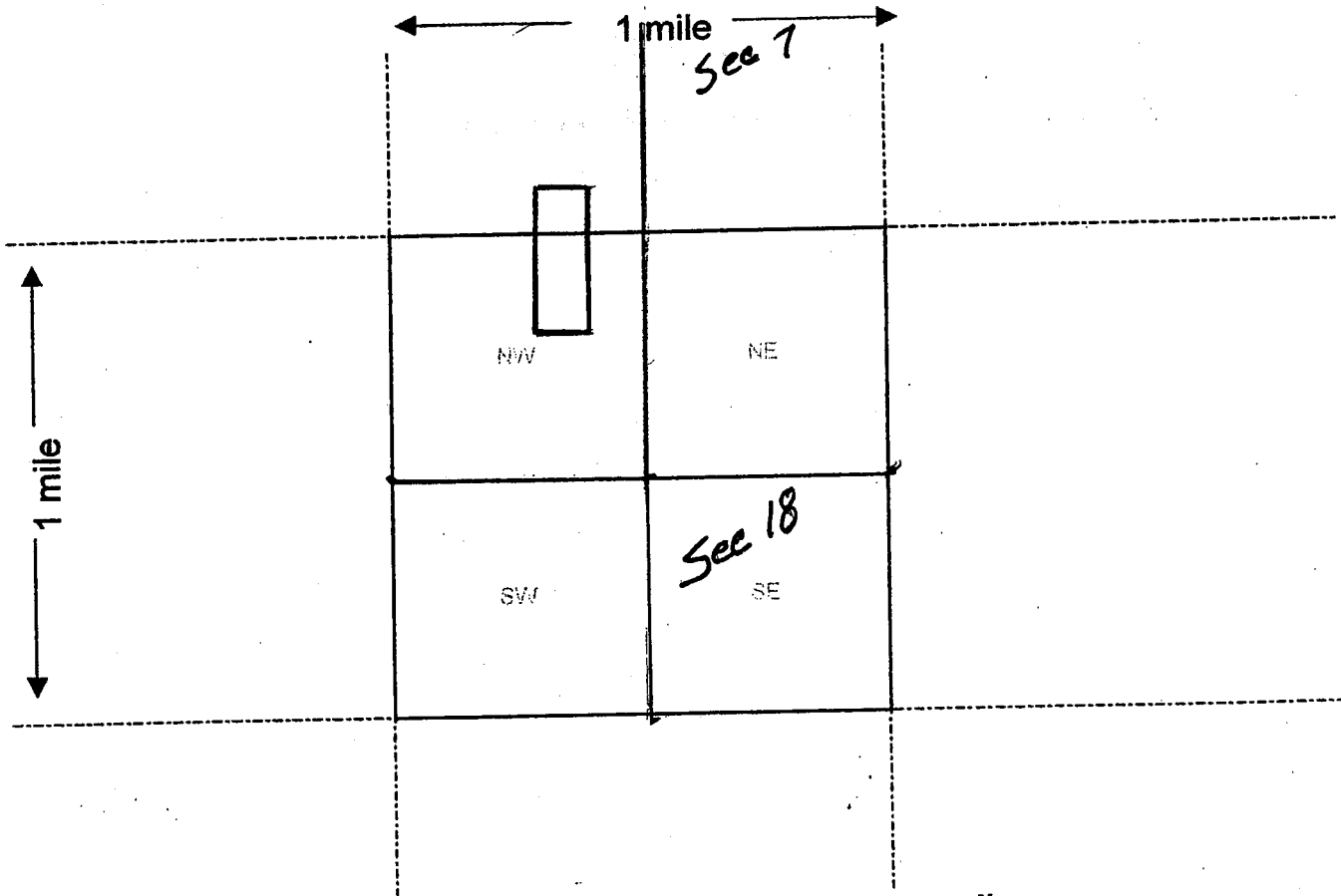

Scale : 1" = 2000 feet



1. The above map depicts the VAN Nostrand-McCaffery Mine #3 mining claim, which is located in Section (s)  
7 AND 18, Township 21 SOUTH, Range 10 EAST, Gila and Salt River Base and Meridian,  
Pima County, Arizona.

2. The type of corner and location monuments used are as follows: STONE AND POST

3. The bearings and distances in degrees and feet between claim corners are as depicted on the map.

Form MCF100a  
 Revised July 2005



LOCATION NOTICE FOR LODE MINING CLAIM

NOTICE IS HEREBY GIVEN that the VAN Nostrand -  
McCafferty Mine #4 lode mining claim has been located  
by Bluefire Gold Co. LLC, whose current mailing  
address is P.O. Box 1916  
Tubac, Az. 85646

RECEIVED  
BLM, AZ STATE OFFICE  
2011 SEP - 6 A 11: 15  
PHOENIX, AZ  
BLM  
Date  
Stamp

The general course of this claim is NORTH TO SOUTH and it is situated in Pima  
County, Arizona. This claim is 1,500 feet in length and 600 feet in width. This claim runs  
from the location monument on which this location notice is posted approximately 750 feet in a  
southerly direction to the south end line and 750 feet in a northerly direction to the  
NORTH end line. This claim is marked by six monuments, one at each corner and one at the center of each  
end line of the claim.

The location monument on which this notice is posted is situated within Section 18, Township 21 SOUTH  
Range 10 EAST, Gila Salt River Base and Meridian, Arizona and this claim encompasses portions  
of the following quarter section (s), section (s), Township (s) and Range (s) NW 1/4, SEC 18, AND  
SW 1/4 SEC 7, T 21 S, R 10 E.

Gila Salt River Base and Meridian, Arizona.

The locality of this claim with reference to some natural object or permanent monument and additional information  
(if any) concerning its locality are as follows: 3/4 mile NNW of Bm 3566

DATED AND POSTED on the ground this 12<sup>th</sup> day of September, 20 11.

LOCATOR (s) Bluefire Gold Co. LLC

Agent - Vincent Pulino 

Form MCF100  
Revised July 2005

AMC410447

**MINING CLAIM MAP**

Lode (X) Placer ( )

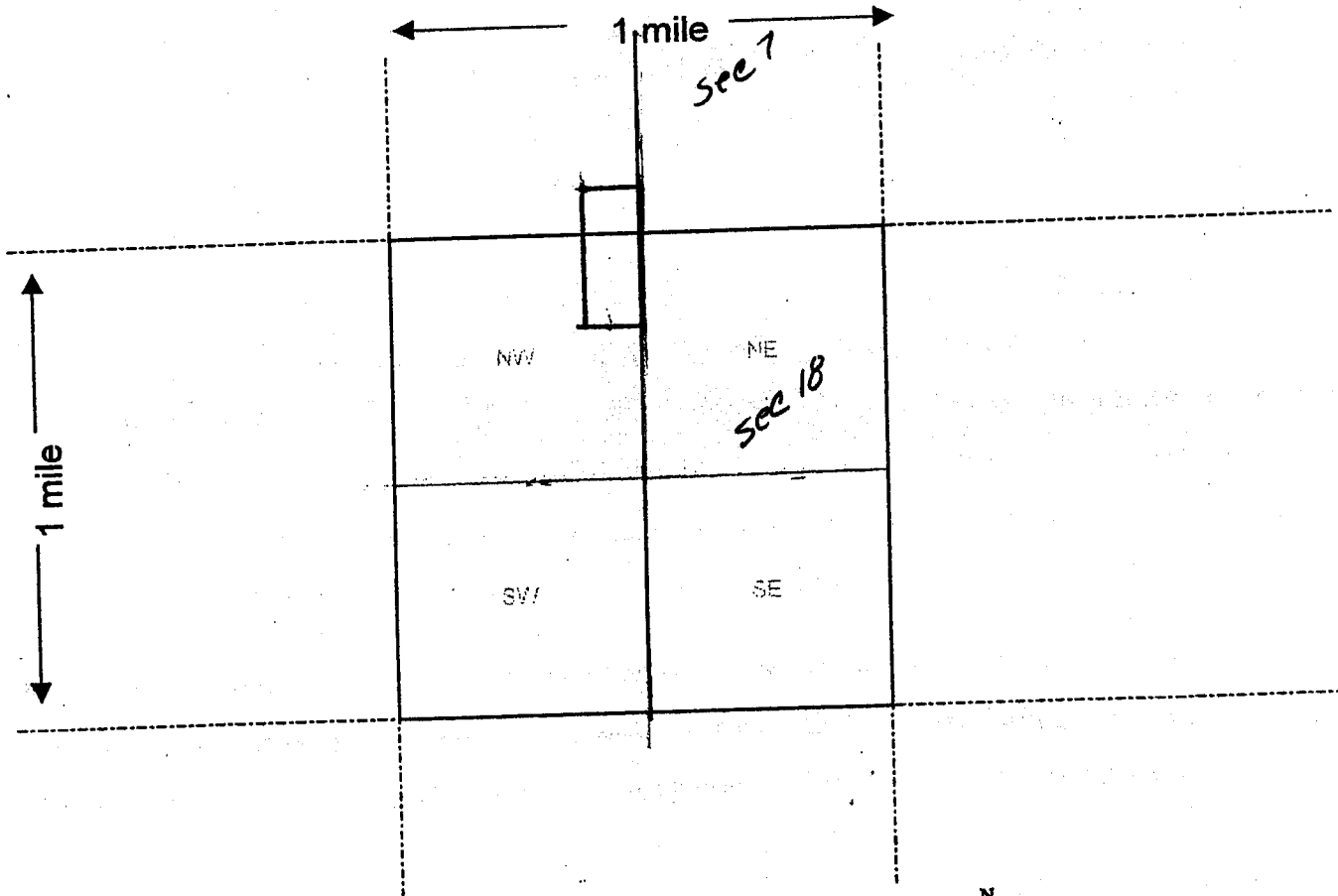

Scale : 1" = 2000 feet

1. The above map depicts the VAN Nostrand-McCafferty Mine #4 mining claim, which is located in Section (s) 7 and 18, Township 21 SOUTH, Range 10 EAST, Gila and Salt River Base and Meridian, Pima County, Arizona.

2. The type of corner and location monuments used are as follows: stone and Post

3. The bearings and distances in degrees and feet between claim corners are as depicted on the map.

Form MCF100a  
Revised July 2005

LOCATION NOTICE FOR LODE MINING CLAIM

NOTICE IS HEREBY GIVEN that the Van Nostrand -  
m'cCafferty Mine #5 lode mining claim has been located  
by Bluefire Gold Co. LLC whose current mailing  
address is P.O. Box 1916  
Tubac, Az. 85646

RECEIVED  
BLM, AZ STATE OFFICE  
2011 SEP -6 A 11: 15  
PHOENIX, AZ  
BLM  
Date  
Stamp

The general course of this claim is North to south and it is situated in Pima  
County, Arizona. This claim is 1,500 feet in length and 600 feet in width. This claim runs  
from the location monument on which this location notice is posted approximately 750 feet in a  
southerly direction to the south end line and 750 feet in a northerly direction to the  
NORTH end line. This claim is marked by six monuments, one at each corner and one at the center of each  
end line of the claim.

The location monument on which this notice is posted is situated within Section 7, Township 21 South  
Range 10 EAST, Gila Salt River Base and Meridian, Arizona and this claim encompasses portions  
of the following quarter section (s), section (s), Township (s) and Range (s) SW 1/4, sec 7,  
T 21 S, R 10 E

Gila Salt River Base and Meridian, Arizona.

The locality of this claim with reference to some natural object or permanent monument and additional information  
(if any) concerning its locality are as follows: 1 mile NNW of BM 3566

DATED AND POSTED on the ground this 1st day of September, 20 11.

LOCATOR (s) Bluefire Gold Co. LLC  
Agent - Vincent Galindo

Form MCF100  
Revised July 2005

ANC410448

MINING CLAIM MAP

Lode  Placer ( )

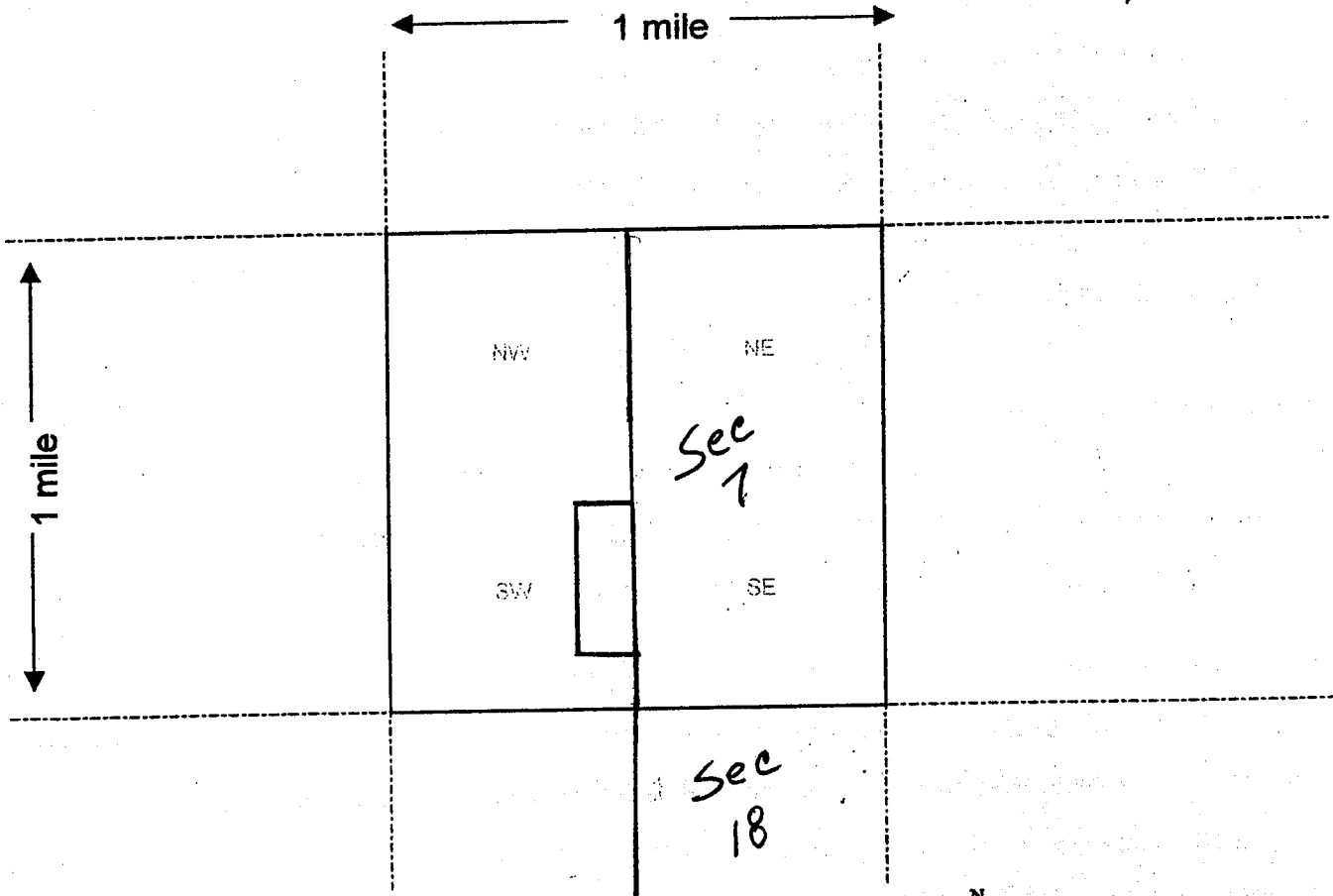

Scale : 1" = 2000 feet

1. The above map depicts the Van Nostrand-McCarthy Mine #5 mining claim, which is located in Section (s) 7, Township 21 SOUTH, Range 10 EAST, Gila and Salt River Base and Meridian, Pima County, Arizona.

2. The type of corner and location monuments used are as follows: STONE AND POST

3. The bearings and distances in degrees and feet between claim corners are as depicted on the map.

Form MCF100a  
Revised July 2005

DEPARTMENT OF INTERIOR  
BUREAU OF LAND MANAGEMENT

Input Parameters for Geographic Report with Land

System Id = CR

Admin State = AZ

Geo State =

Casetype Begins With

Case Disp Txt = AUTHORIZED, CANCELLED, EXPIRED, PENDING, REJECTED, RELINQUISHED, VOID, WITHDRAWN

Mer Twp Rng =

Section =

Mtrs = 14 0210S 0100E 007, 14 0210S 0100E 018, 14 0210S 0100E 999, 14 0220S 0110E 020, 14 0220S 0110E 025, 14 0220S 0110E 027, 14 0220S 0110E 999

Commodity =

Commodity Txt =

Pending Org =

Pend Org Decode =

Total Rows Returned: 1

RUN TIME: 11:05 AM

UNITED STATES DEPARTMENT OF INTERIOR  
BUREAU OF LAND MANAGEMENT  
GEOGRAPHIC REPORT WITH LAND  
Sorted by Serial Number

RUN DATE: 09/06/2011  
Page 1 of 1

Serial Number: AZA 023584  
Total Case Acres: 21,280.860

<u>Casetype</u>	<u>Case Disp</u>				<u>Sect</u>	<u>Sur Typ</u>	<u>Sur Num</u>	<u>Suff</u>	<u>Subdivision</u>	<u>Act Pend</u>
215003	AUTHORIZED	14	0210S	0100E	007	LOTS			3,4;	

**TOWNSHIP 22 SOUTH RANGE 11 EAST OF THE GILA AND SALT RIVER MERIDIAN, ARIZONA**

SANTA CRUZ / PIMA COUNTY

**STATUS OF PUBLIC DOMAIN  
LAND AND MINERAL TITLES  
AND ACCRUED LANDS**

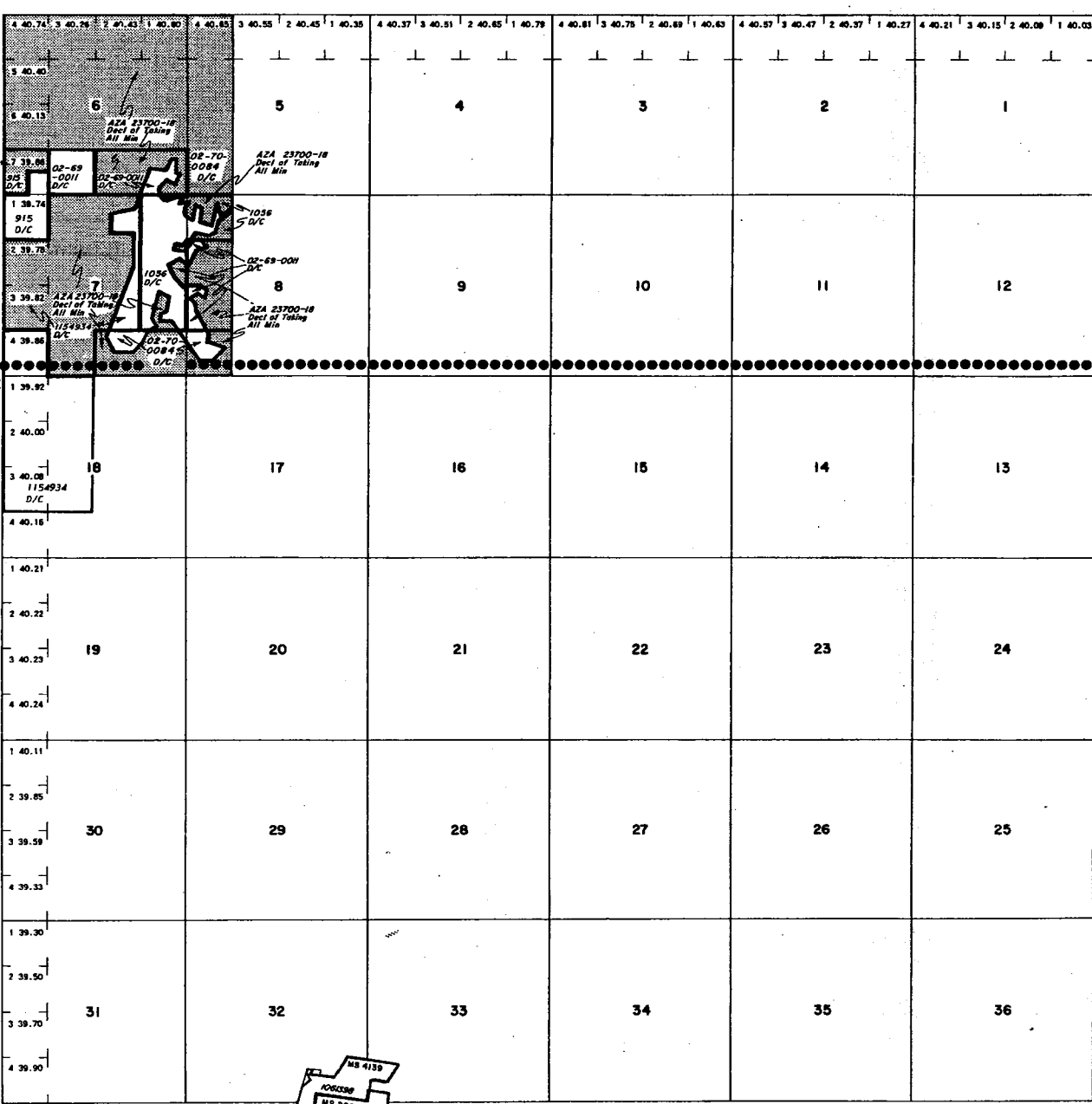

INDEX TO SEGREGATED TRACTS			
REDSURVEY TRACT NO	ORIGINAL SURVEY		
	T	R	SEC

*FOR ORDERS EFFECTIVE DISPOSAL OR USE OF  
UNIDENTIFIED LANDS WITHDRAWN FOR CLASSIFICATION,  
MINERALS, WATER AND/OR OTHER PUBLIC PURPOSES,  
REFER TO INDEX OF MISCELLANEOUS DOCUMENTS.*

*All Tr. included in Vol. Coronado N.E., Page,  
1121 4/17/1911*

*MDS 603 SW*

*ALL TR. INCLUDED IN DE TERMINATION AREA PLAN 2/26/1908  
AN 028-028*

*LIST NO. 4*

CURRENT TO	BY



**WARNING STATEMENT**  
This plat is the Bureau's Record of Title, and should be used  
only as a graphic display of the township survey data. Rec-  
ords herein do not reflect title changes which may have been  
effected by lateral movements of rivers or other bodies of water.  
Refer to the cadastral surveys for official survey information.

TOWNSHIP 21 SOUTH RANGE 10 EAST OF THE GILA AND SALT RIVER MERIDIAN, ARIZONA

PIMA COUNTY

STATUS OF PUBLIC DOMAIN  
LAND AND MINERAL TITLES  
AND ACQUIRED LANDS

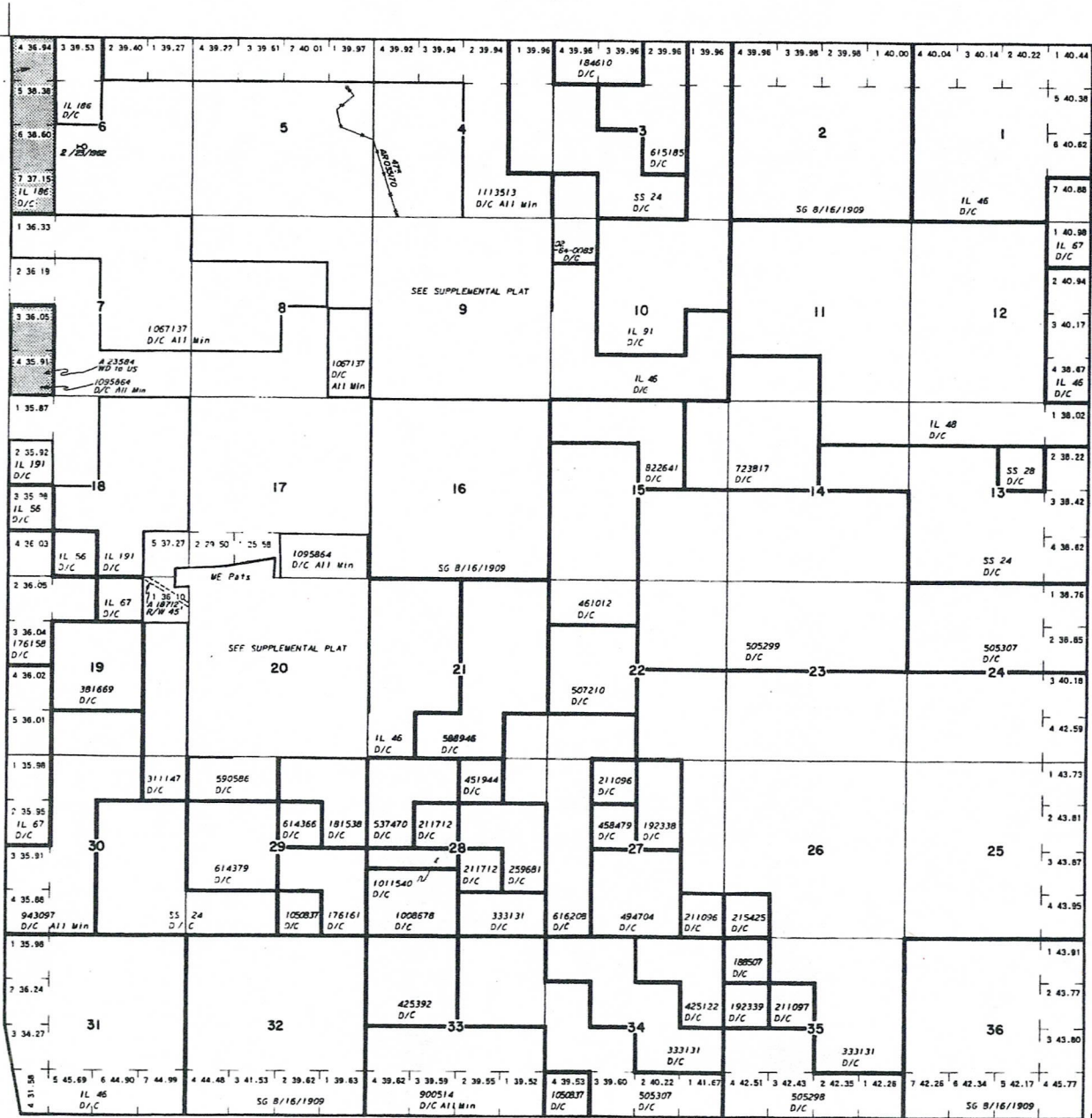

AZA 2370-05  
Sect 1-4 Taking  
All Min.

RESURVEY		ORIGINAL SURVEY	
TRACT NO	T	R	SUBDIVISION

FOR ORDERS EFFECTING DISPOSAL OR USE OF  
UNIDENTIFIED LANDS WITHDRAWN FOR CLASSIFICATION,  
MINERALS, WATER AND/OR OTHER PUBLIC PURPOSES,  
REFER TO INDEX OF MISCELLANEOUS DOCUMENTS.

DIST. NO. 4

MDS S90 NW  
S91 SW

AZA 2122 R/V (Approximately 1.0A)  
Sec 17, NE1/4

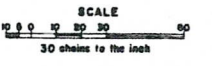

Lat. 31°33'07" N  
Long. 111°16'25" W

**WARNING STATEMENT**  
This plat is the Bureau's Record of Title, and should be used  
only as a graphic display of the township survey data. Rec-  
ords hereon do not reflect title changes which may have been  
effected by lateral movements of rivers or other bodies of water  
Refer to the original surveys for official survey information.

CURRENT TO	BY

T. 21S.  
R. 10E.